



NMEA-2K

FILOS - Manual Controller

Rev.: [A]

Disclaimer

The interceptor units are also steering equipment and it is the sole responsibility of the navigator-operator to ensure that, at any point, any problem that will alter the vessels's course, rising from malfunction of interceptors, should be dealt immediately by the operator. Under no circumstances, fault of our interceptor equipment leading to any kind of accident, creates liability for the manufacturer.

Trademark Notice

HydroTab is a registered trademark of Olympic Engineering Ltd, Greece. All other trademarks, trade or company names referenced herein are used for identification only and are property of their respective owners.

Patent Notice

HydroTab products are protected by patents and industrial design patents, patents pending or design patents pending.

Declaration of Conformity

This product conforms to the following Electromagnetic Compatibility (EMC) regulations and standards for use in marine environments:

CE EN 60945

Technical Information and Documentation

The technical information provided in this document was accurate and correct at the corresponding production time of the HydroTab interceptors. Our operating principal for improving the manufactured product, may lead to changes regarding its specs, without prior notice. Liability will not be held for any inaccuracy, considering the product and the user manual.

Fair Use Statement

This manual can be printed or copied for private use only. Copies should not be provided to third parties and manual should not be commercialized.

Product Disposal

Waste removal of this product must be done, according to the Waste Electrical and Electronic Equipment (WEEE) Directive.

Product Registration

Please register your product online in order for the warranty to be valid.

Table of Contents

Disclaimer.....	2
Overview	4
Technical Data.....	4
Mounting Instructions	5
Direct Installation Diagram.....	6
Installation on Existing NMEA Network Diagram	6
NOTES.....	6

OVERVIEW



FILOS Manual Controller - Overview		
1	System Operation Mode	1. Manual: Manual operation of the interceptors. 2. Auto Pitch: Interceptors position adjusted, according to the current vessel speed. 3. Full Auto: Auto Pitch & Roll Operation, for optimal cruising behavior.
2	LED Gauge Column	Interceptor Deployment Indication
3	Main Button	Multi Functional Joystick Button Slide ⬅️ (up left) to switch between the Operation Modes (illuminated accordingly). Slide ➡️ (up right) and hold for 2 seconds switch between Day/Night Mode Slide ➡️ (up right) and hold for 4 seconds to change the LEDs' colors .

! IMPORTANT NOTE: FILOS Controller operates EXCLUSIVELY on Manual Mode, as a standalone device. If it is installed in an already existing NMEA Network that contains “TheHUB”, or “MOBY Controller”, then, all the Operation Modes become available to the boat’s operator.

TECHNICAL DATA

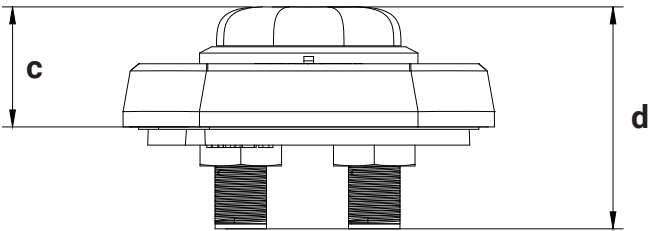
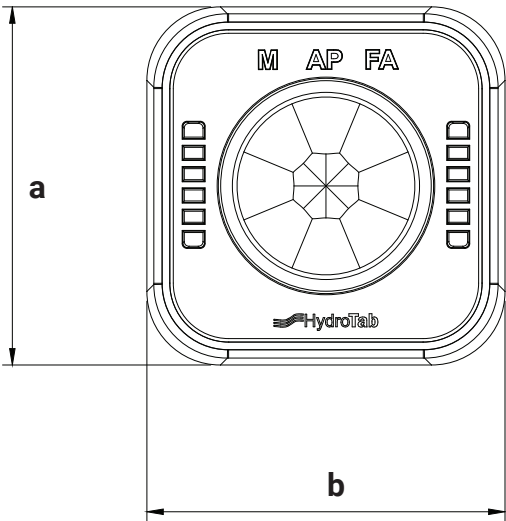

External Dimensions	
Length (a)	77 mm
Width (b)	77 mm
Height (c)	25 mm
Height w/ NMEA Ports (d)	46 mm

MOUNTING INSTRUCTIONS



1

1. Unhinge **carefully** and lift the controller's top body cover.

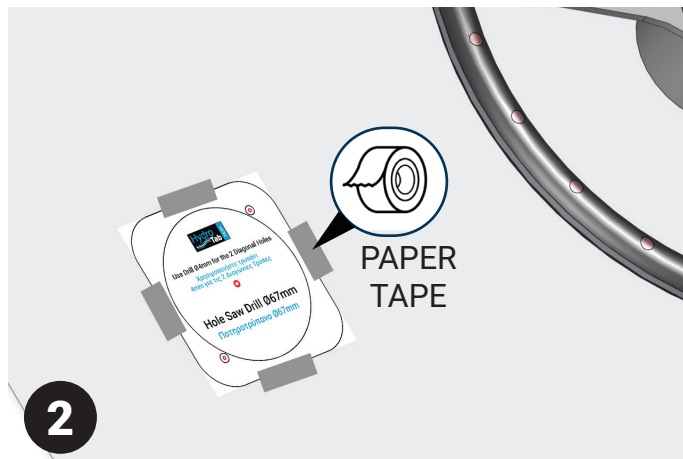

2

2. Place the "FILOS Drilling Pattern" in the desired position, preferably a clean and easy-to-access area, close to the vessel's steering wheel.



3

3A. Drill the 2 diagonal holes, according to the provided drilling pattern, with 4 mm bore.
3B. Drill the central hole, with a Ø67mm Hole Saw Drill Bit.

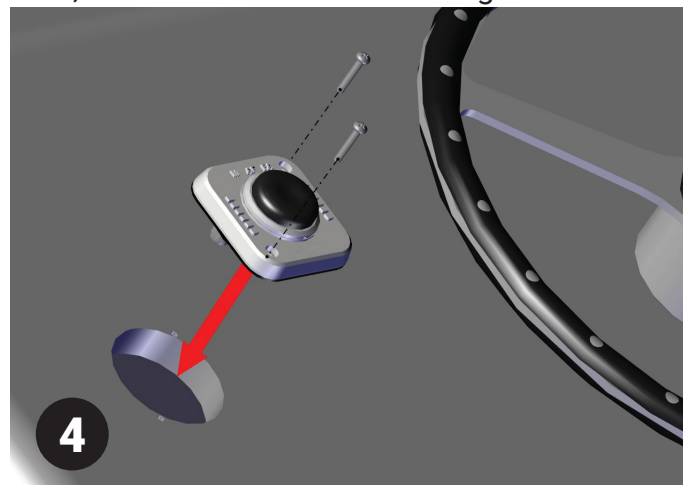

4

4. Place the device onto position, and mount it, with the provided screws.

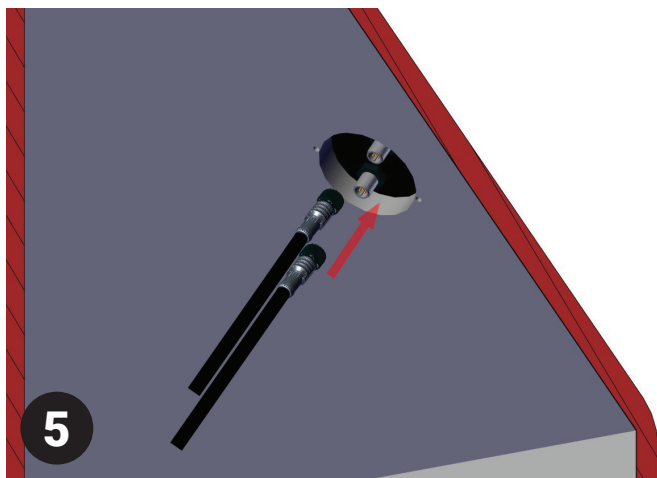

5

5. Mount the connection plugs in the 5-pole ports.

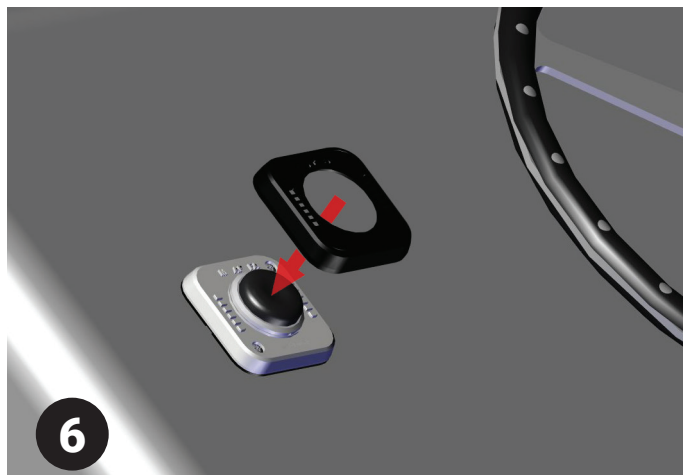

6

6. Place the controller's top body cover, until you hear it "clicking" onto position.

DIRECT INSTALLATION DIAGRAM

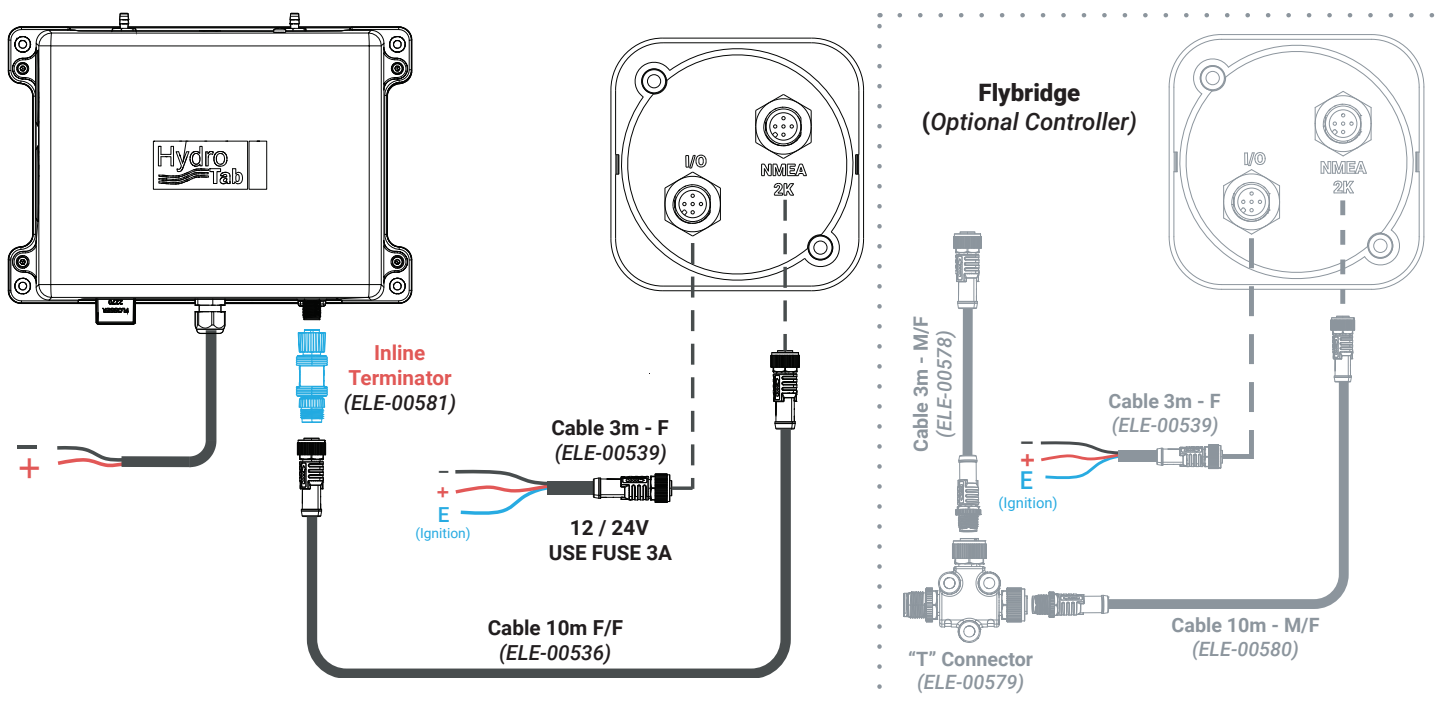

NOTE: In case a new NMEA-2K instrument needs to be added, a proper NMEA Network must be built.

INSTALLATION ON EXISTING NMEA NETWORK DIAGRAM

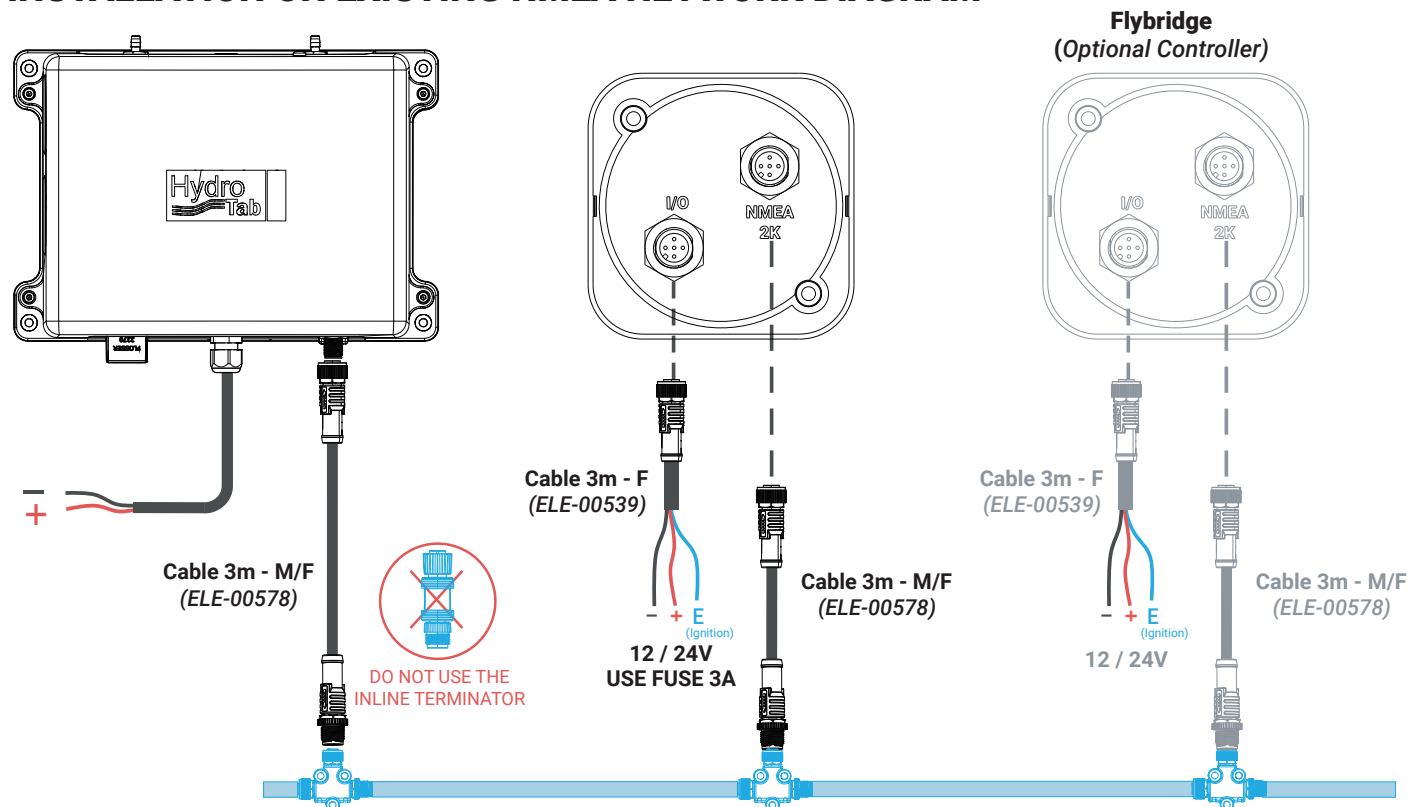

NOTE: If there is only one helm station with a protective roof and no other available GPS sources, an external GPS signal may be necessary.

NOTES



4, Papazoglou Str.
GR-17778 Athens
Greece
email: info@hydrotab.gr
website: www.hydrotab.gr