

## **Disclaimer**

The interceptor units are also steering equipment and it is the sole responsibility of the navigator-operator to ensure that, at any point, any problem that will alter the boat's course, rising from malfunction of interceptors, should be dealt immediately by the operator. At no circumstances, fault of our interceptor equipment leading to any kind of accident, creates liability for the manufacturer.

## **Trademark Notice**

Hydrotab is a registered trademark of Olympic Engineering Ltd, Greece. All other trademarks, trade names or company names referenced herein are used for identification only and are property of their respective owners.

## **Patent Notice**

The Hydrotab products are protected by patents and industrial design patents, patents pending or design patents pending.

## **Declaration of conformity**

This product conforms to the following Electromagnetic Compatibility (EMC) regulations and standards for use in marine environments.

CE EN 60945

## **Technical information and Documentation**

The technical information provided in this document was accurate and correct at the corresponding production time of the Hydrotab interceptors. Our operating principal for improving the manufactured product, may lead to changes regarding its specifications without prior notice. Liability will not be accepted for any inaccuracy considering the product and the user manual.

## **Fair use statement**

This manual can be printed or copied for your own use only. Copies should not be provided to third parties and manual should not be commercialized.

## **Product Disposal**

Waste removal of this product must be according to the Waste Electrical and Electronic Equipment (WEEE) Directive.

## **Product Registration**

Please register your product online in order the warranty to be valid.

## TABLE OF CONTENTS

Disclaimer	2
Installation Kit	4
Required Tools for Installation	5
Before Installation	5
Safety precautions	5
Proper Interceptor Installation in Transom	6
Interceptor Installation	7
BT Series Interceptor and Anode Mounting and Coating Instructions	13
Interceptor Installation (Indirect Air Supply)	14
Air Unit Installation	14
Installation Schematic overview (One Set of Rocker Switches)	16
Installation Schematic overview (Two Sets of Rocker Switches)	16
Air Unit Electrical Diagram	17
Air Unit Pneumatic Diagram	18
Spare Parts List - Model: 160BT (ASM-00928)	19
Spare Parts List - Model: 320BT (ASM-00560)	20
Spare Parts List - Model: 480BT (ASM-00561)	21
Spare Parts List - Model: 640BT (ASM-00562)	22
Spare Parts List - Model: 800BT (ASM-00563)	23
Spare Parts List - Model: 960BT (ASM-00564)	24
Spare Parts List - Model: 1500BT (ASM-00940)	25
Spare Parts List - Model: 2000BT (ASM-00941)	26
Spare Parts List - Air Unit (ASM-00834)	27
Warranty Conditions	28
Troubleshooting	29

## Installation Kit

### 1. Two interceptors

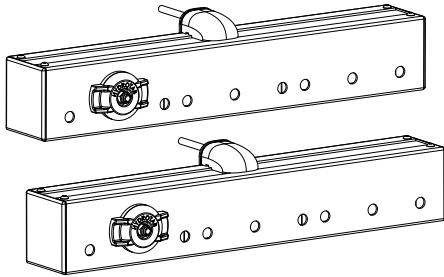

### 2. 12V Air Unit

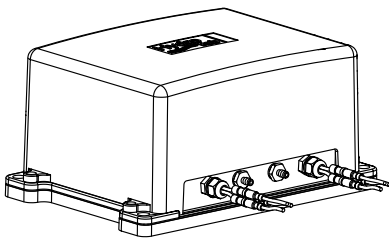

Extra 24V Relay

### 3. Rocker Switches

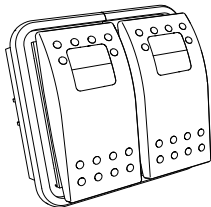

### 4. Pipe 8mm

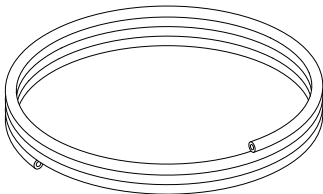

### 5. Connection cable

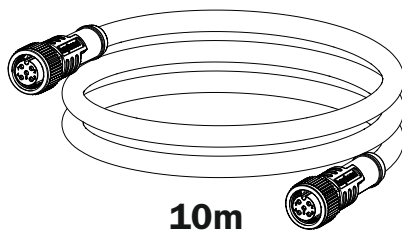

### 6. Two drilling patterns

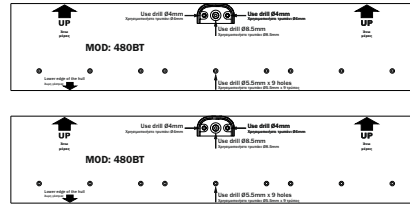

### 7. Fittings

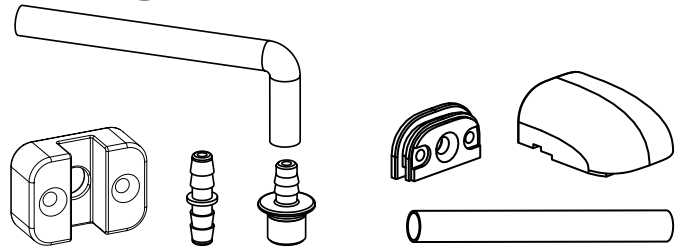

### 8. Screws



Air Unit wall mounting screws (4,8x25)



3DHC controller mounting screws (3,5x13)



Interceptor mounting screws (6,3x32)



Fitting mounting screws (4,8x25)



Indirect air supply pipe holder mounting screws (3,5x13)

### Required Tools for Installation



### Before Installation

Make sure there are no obstructions behind the drilling area (tanks, fuel lines, cabling) which can be damaged or prevent the installation (Figure 1).

**Attention!** Please make sure that the pipe insertion hole is accessible from the engine room (Figure 2).

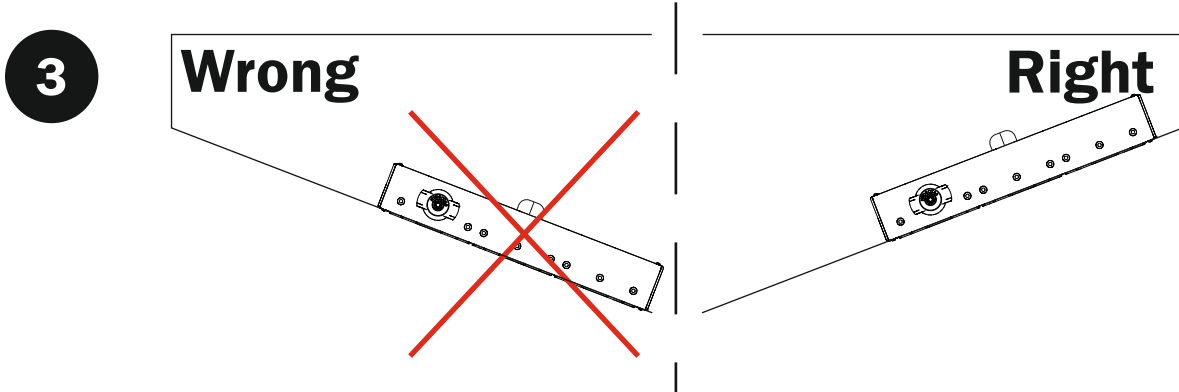
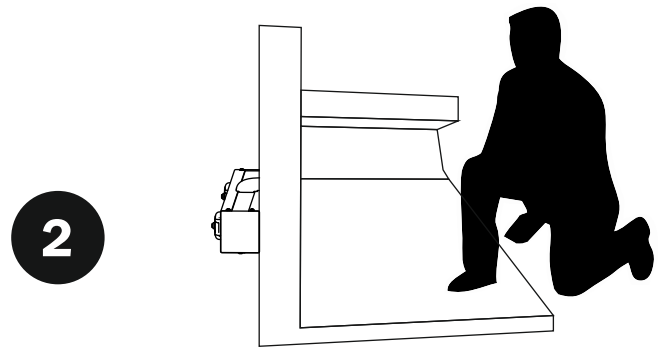
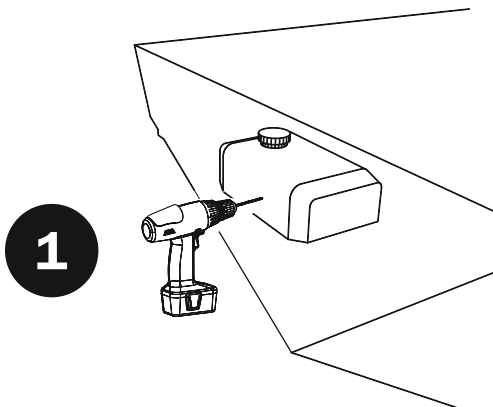

A good hint is that the closer the units are to the water line, the best the bank control of the boat will be (Figure 3).

### WARNING!

### Safety precautions

1. For high speed boats, overtrim may cause unexpected turn. Improper use of trim tabs, may result to accident or injury.
2. Please DO NOT PLACE YOUR FINGERS INSIDE THE INTERCEPTOR, through the front holes (Figure 4).

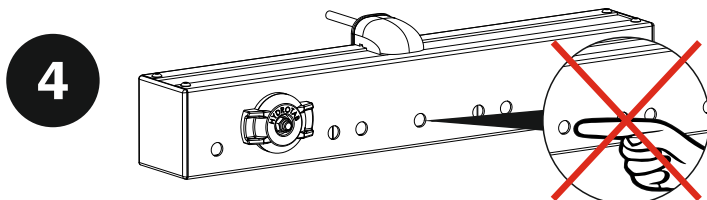

**Proper interceptor installation in transom**

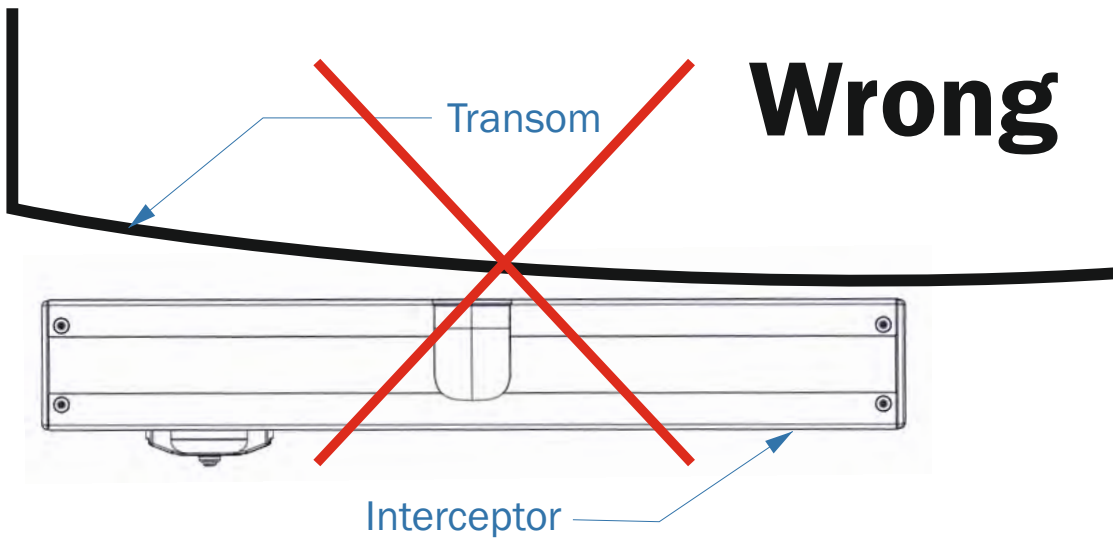
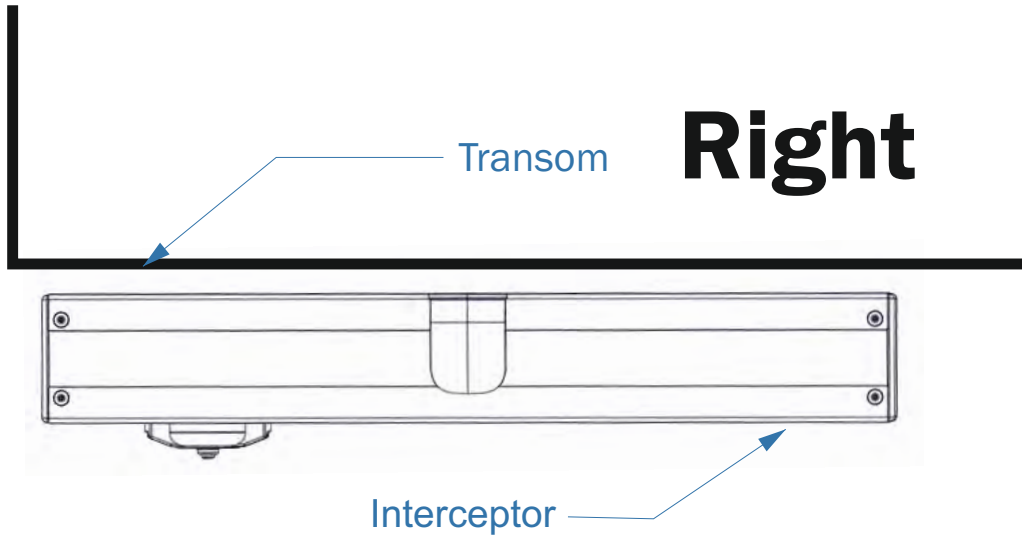

If the boat's transom has a significant curvature, it is necessary to create a flat plane for the installation (acceptable flatness tolerance: 2mm).

For aluminum hulls, it is suggested Isolation Plates between hull and interceptors to be installed. You can find installation instructions in the Isolation Plates Kit.

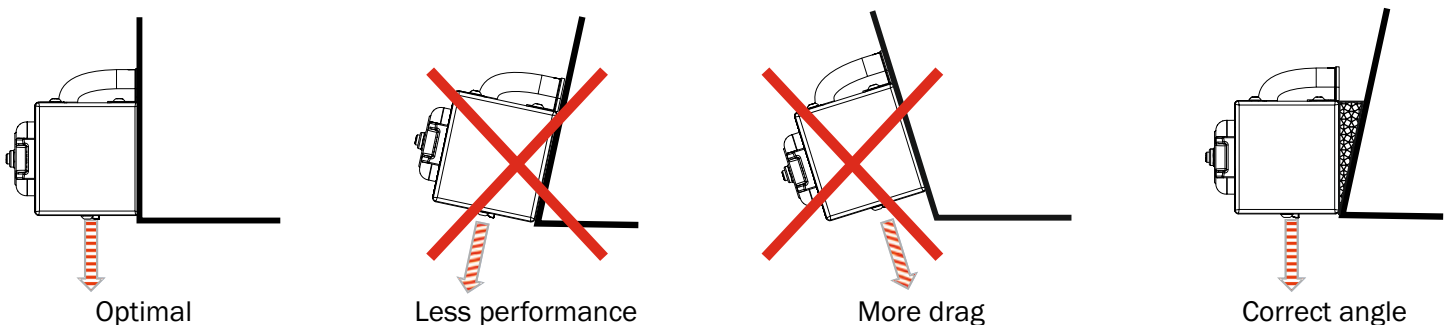

For maximum performance and less drag, install interceptors on the transom so blades deploy vertically. If transom is not vertical to water plane, correct the angle by using wedges or other means.

## Interceptor Installation

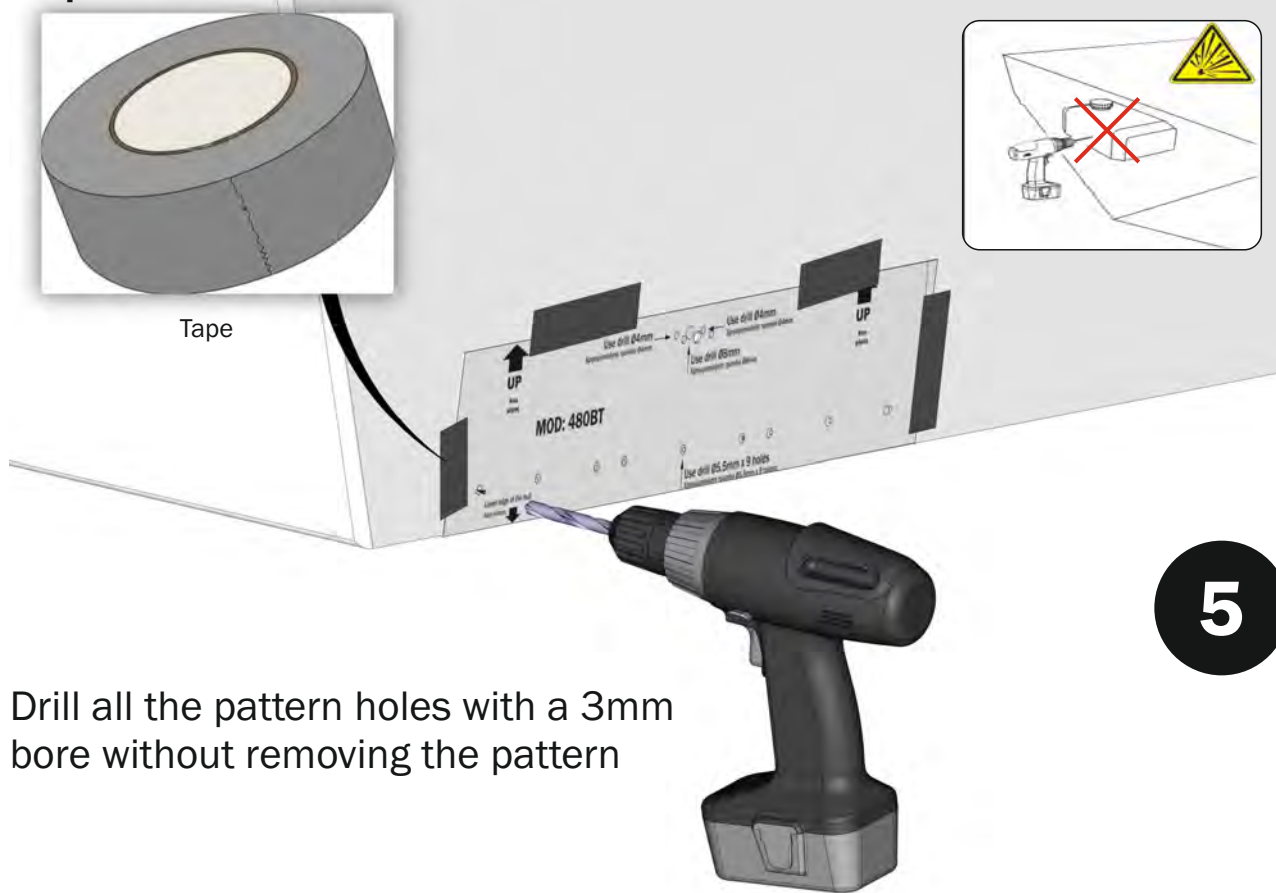

Drill all the pattern holes with a 3mm bore without removing the pattern

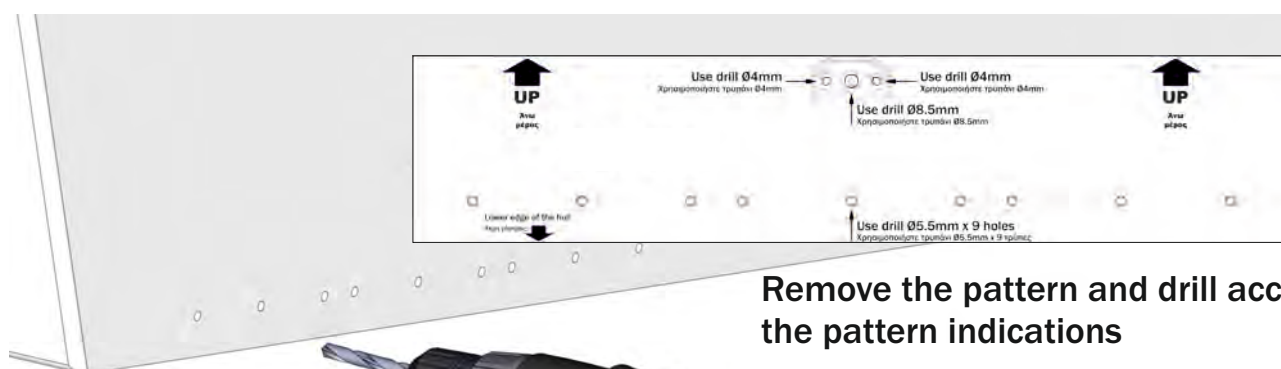

Remove the pattern and drill according to the pattern indications

You will need

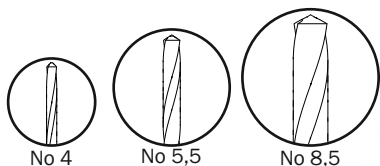

## Interceptor Installation

### Optional: Connecting Interceptors with Earthing Grid of boat

Except periodical replacement of anodes, you can enhance protection of interceptors from electrolytic corrosion by connecting them to the earthing grid of the boat:

1. Drill through the hull one of the mounting pattern-holes on the transom.
2. Replace one regular self-tapping mounting screw (M6,3x32), with a longer screw (Inox 316,  $\Phi 6.3\text{mm}$ ) so to run through the transom wall (use sealant before tightening the screw).
3. Connect the screw with earthing grid of boat.

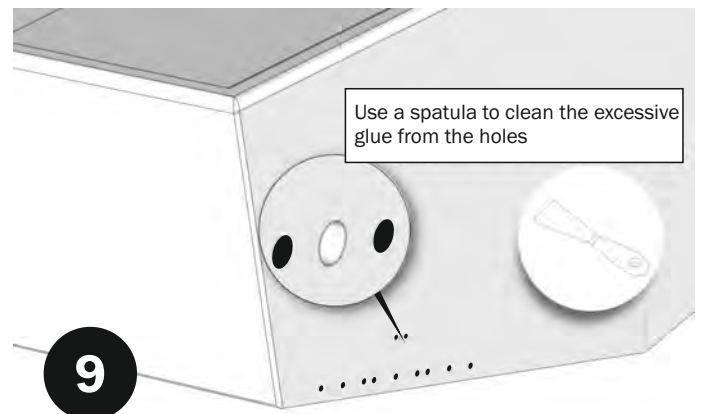
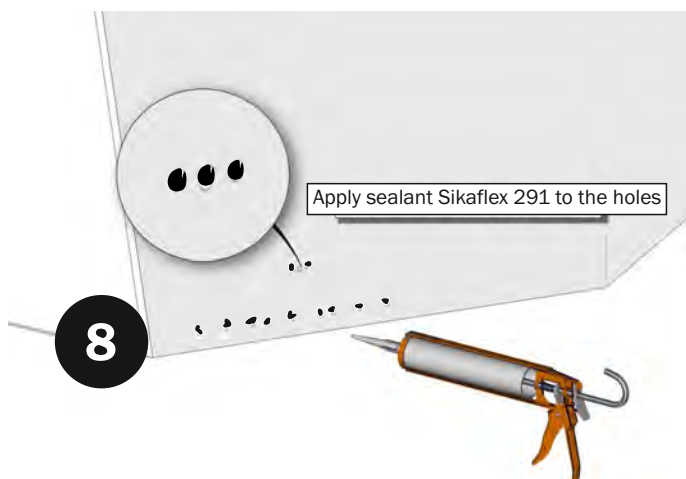
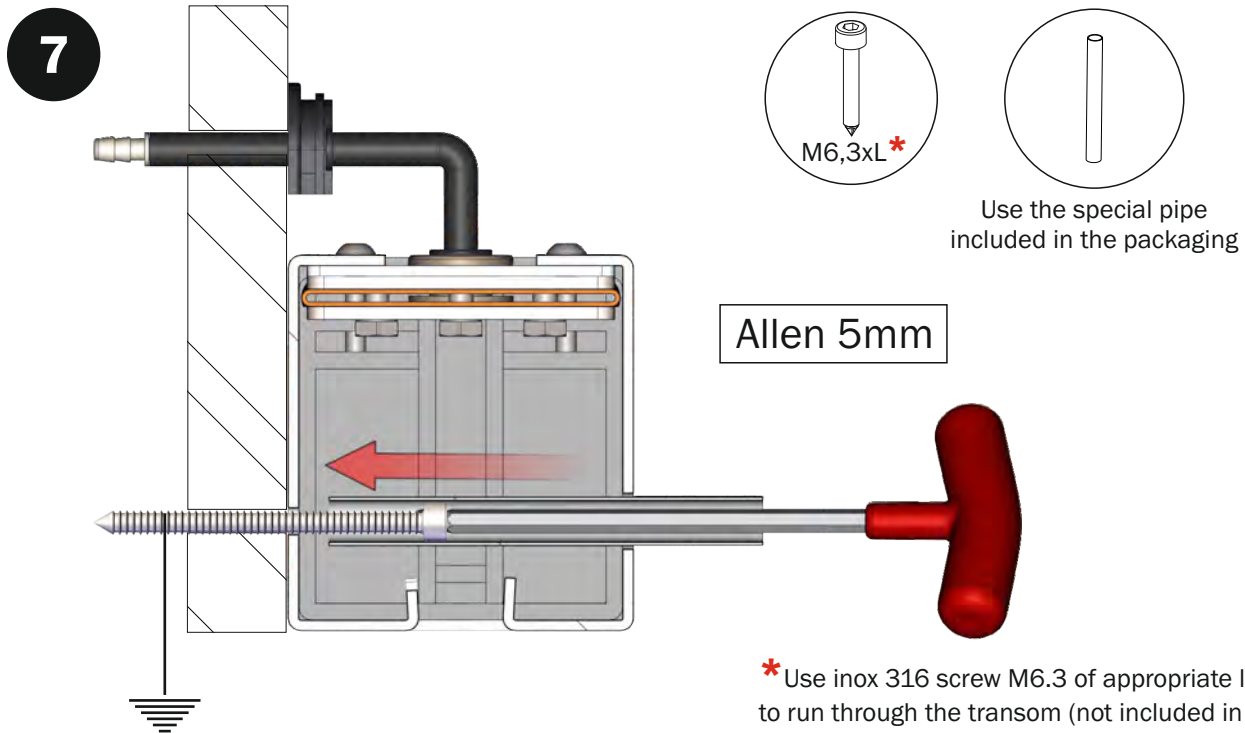



## Interceptor Installation



**10**

Direct air supply

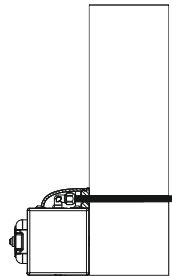

**Optional:**  
Indirect Air Supply Kit

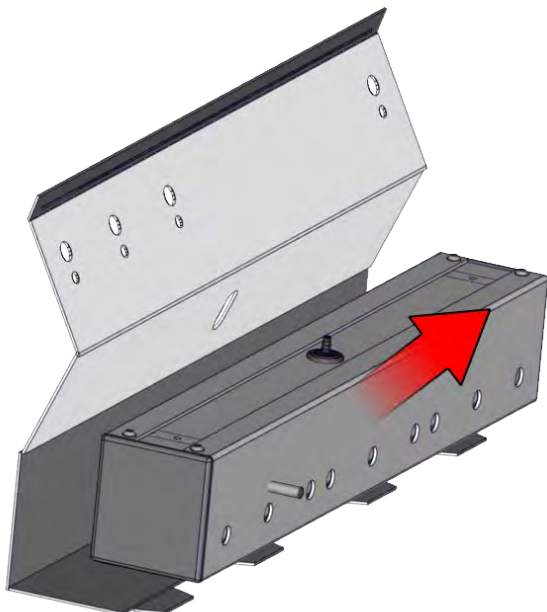
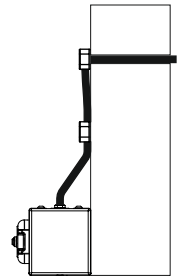

**11**

## Interceptor Installation

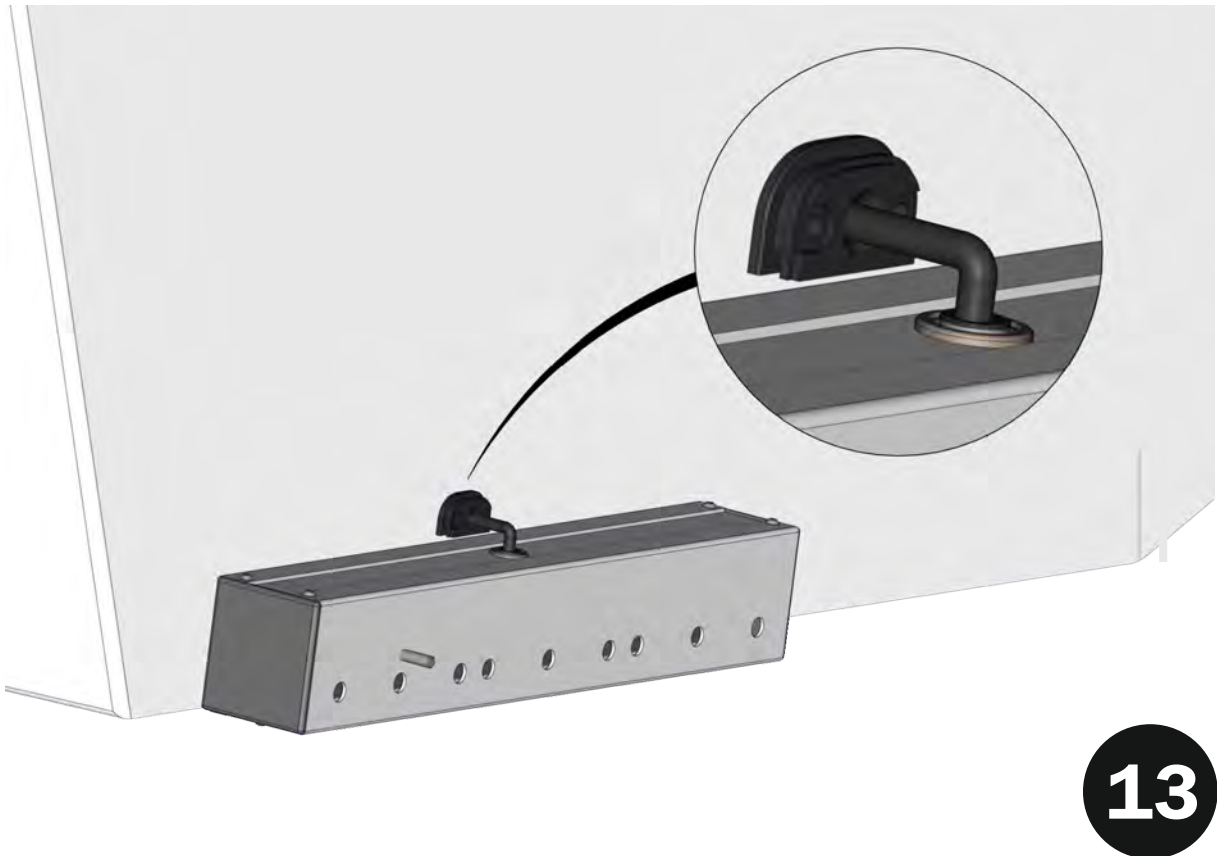
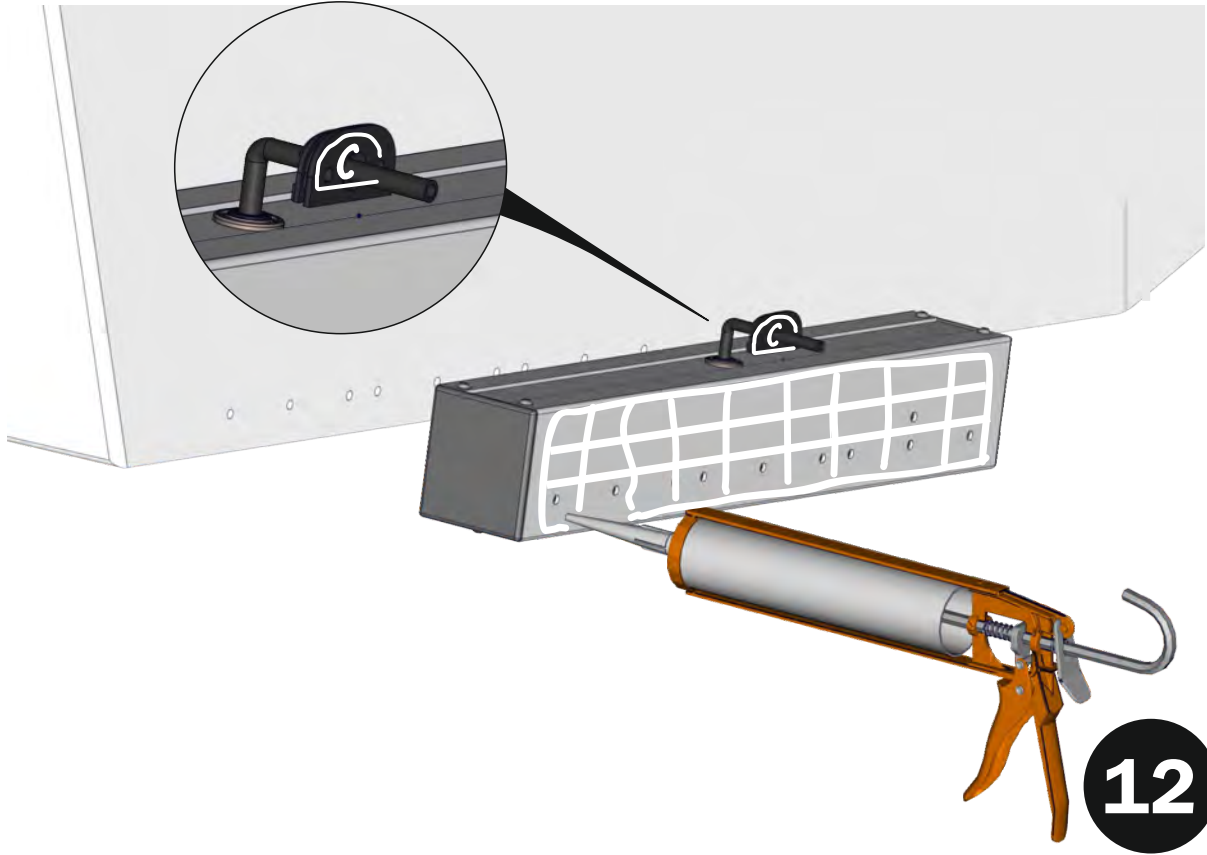

**Interceptor Installation**

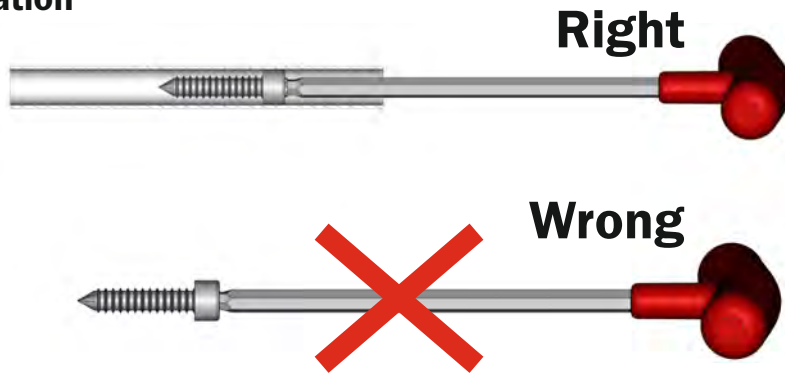

**! WARNING!** Do not try to place the screw without using the guide pipe!  
If the screw falls in the internal of the interceptor, you must disassemble the rear plastic cover, and restore the screw.

**14**

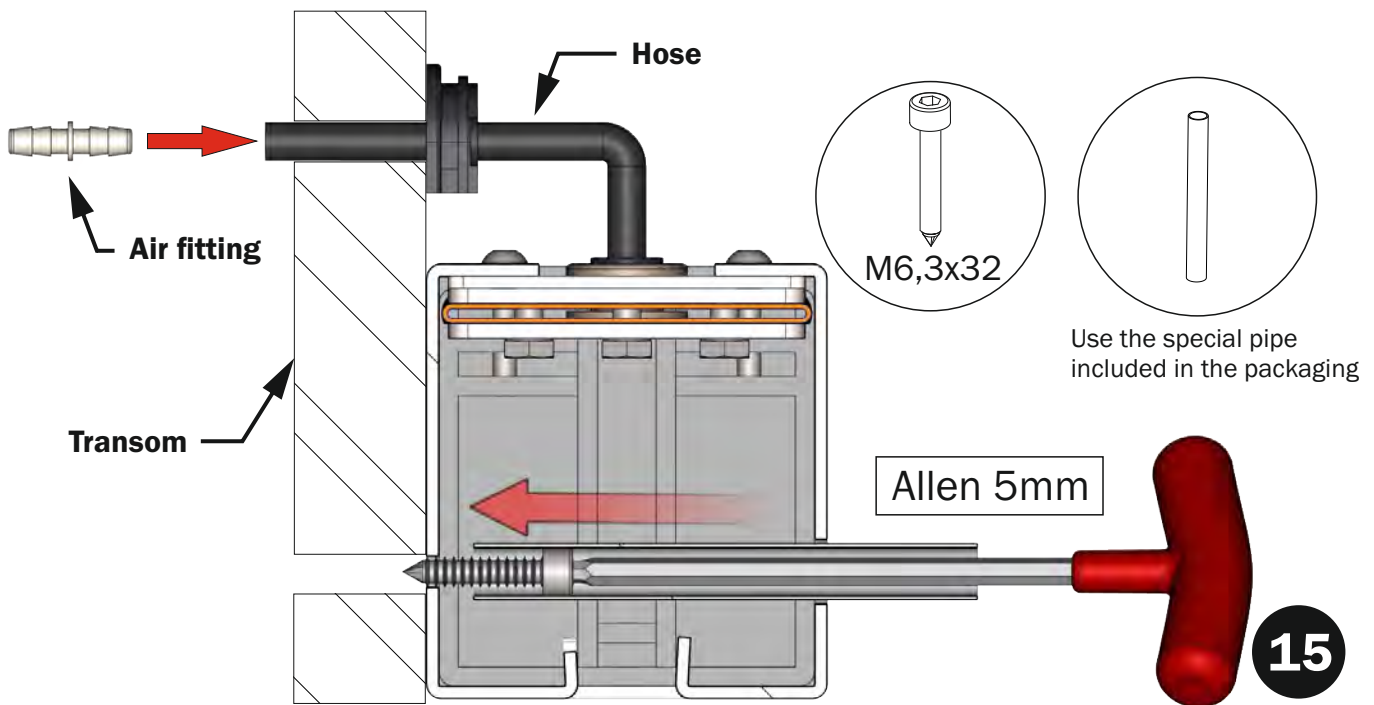

**15**

**! WARNING!** After you install the hose through the transom, mount the air fitting into the hose

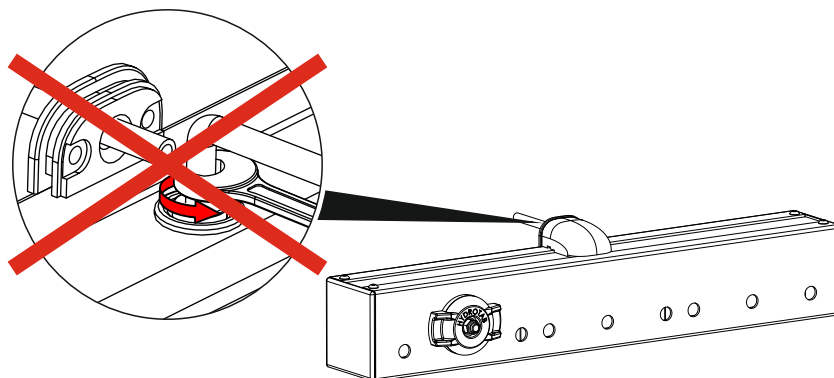

**! WARNING!** Do not try to dismantle the interceptor's air fitting!  
Danger of damaging tubular's leakproof !!!

**16**

## Interceptor Installation

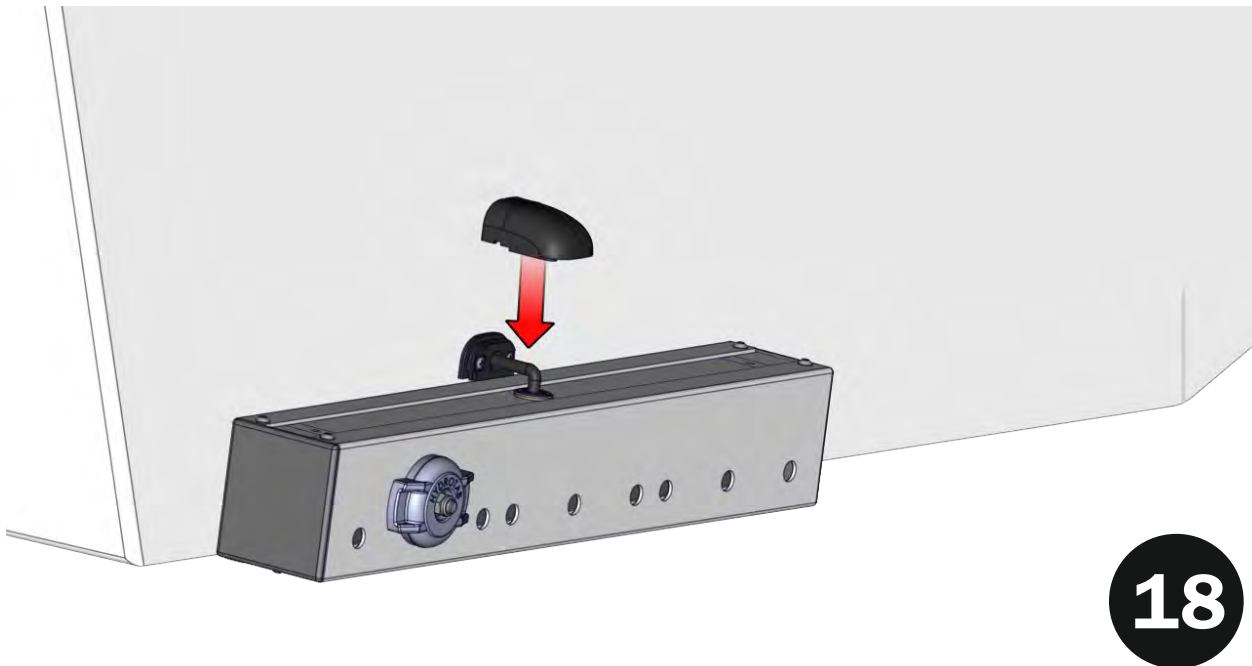
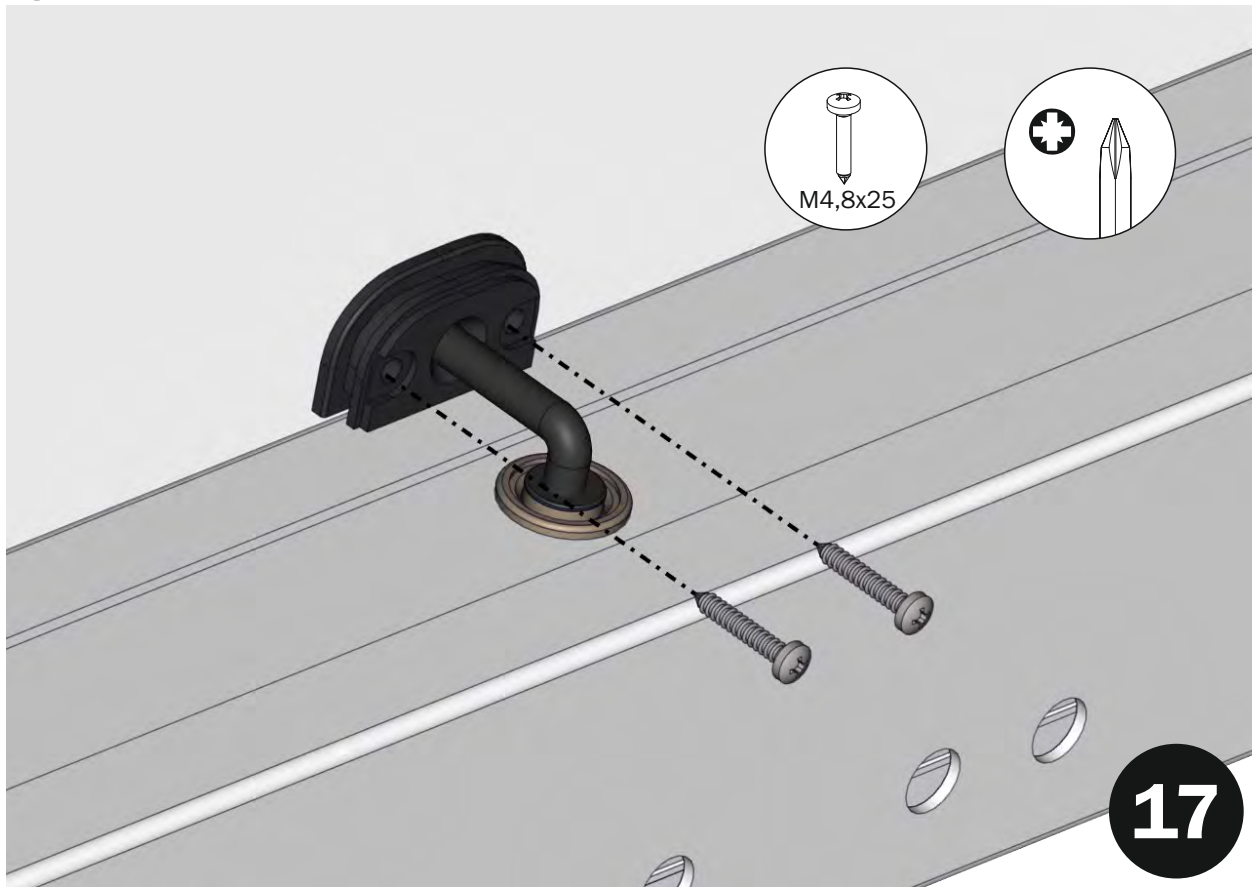

**Attention!** The anodes replacement, depends on the sea water quality you have dropped anchor. As the corrosion of an anode looks like a sponge, for more efficient checking you should touch it to feel that its smooth surface has become porous. We suggest a precautionary monthly inspection and replacement before anodes mass is worn over 50%.

## BT Series Interceptor and Anode Mounting and Coating Instructions

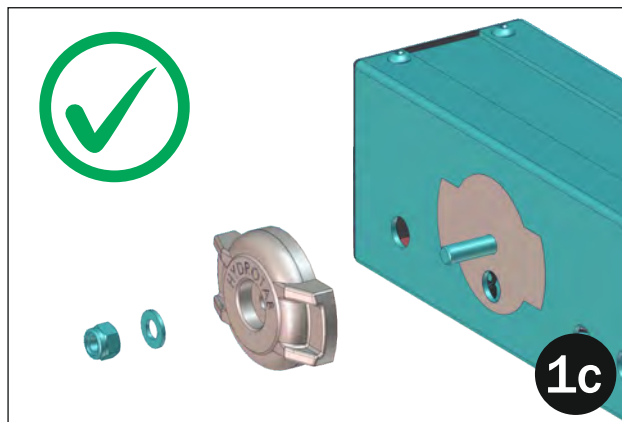
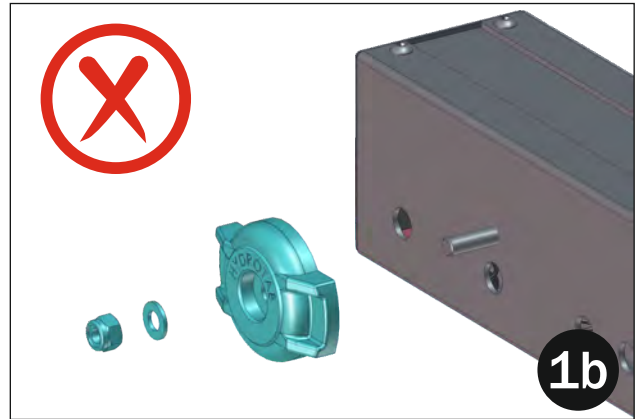

**Note 1:** You may apply protection coating on interceptor if you'd like so, but:

1. Do not apply coating on anodes
2. Do not apply coating on the area of interceptors which is in contact with anode (see Fig. 1a, 1b, 1c).

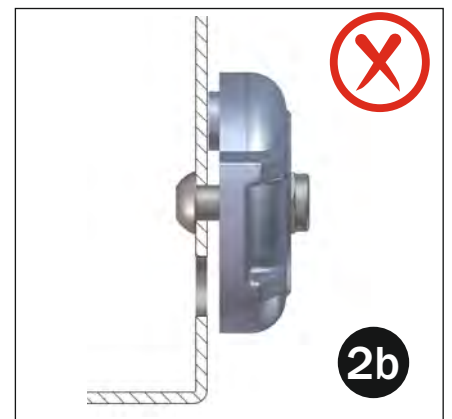
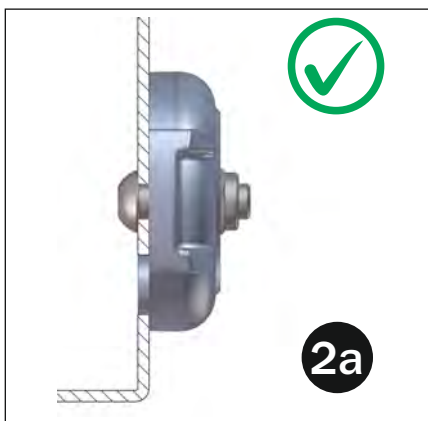

**Note 2:** Mount anode to the interceptor, so the bump of anode fits into the hole of the interceptor. Then tight the mounting bolt so interceptor and anode be in direct contact. (see Fig. 2a, 2b).

**Note 3:** When in brackish or fresh water, use Magnesium anodes instead of Zinc (Zinc anodes are pre-installed and they are appropriate only for sea-water).

**Note 4:** Check often condition of anodes and replace them when they lose about 50% of their mass. Life time of anodes cannot be easily predetermined because it is related to sea-water characteristics as well as other factors of sea environment.

## Interceptor Installation (indirect air supply)

In case of indirect air supply, you can use the components included in the kit as shown in the image.

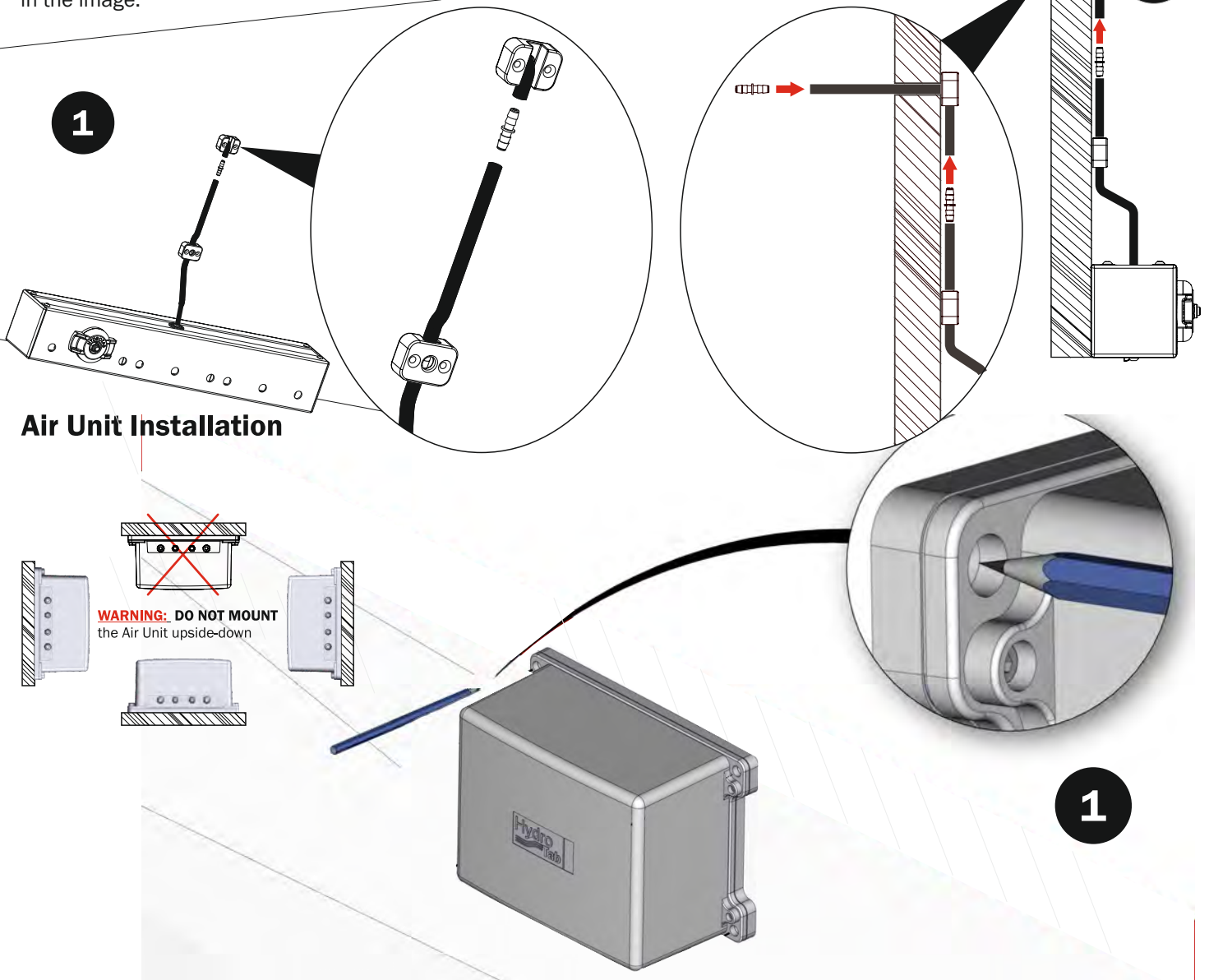

**WARNING:** THE AIR UNIT MUST BE INSTALLED IN A COMPARTMENT **FREE OF EXPLOSIVE OR FLAMMABLE GASES**

**WARNING:** PLEASE INSURE THAT THE AIR UNIT IS INSTALLED ACCORDING TO THE IP30 LIMITATIONS.

IP30: Protected from tools and wires greater than 2.5 millimeters. Not protected from liquids.

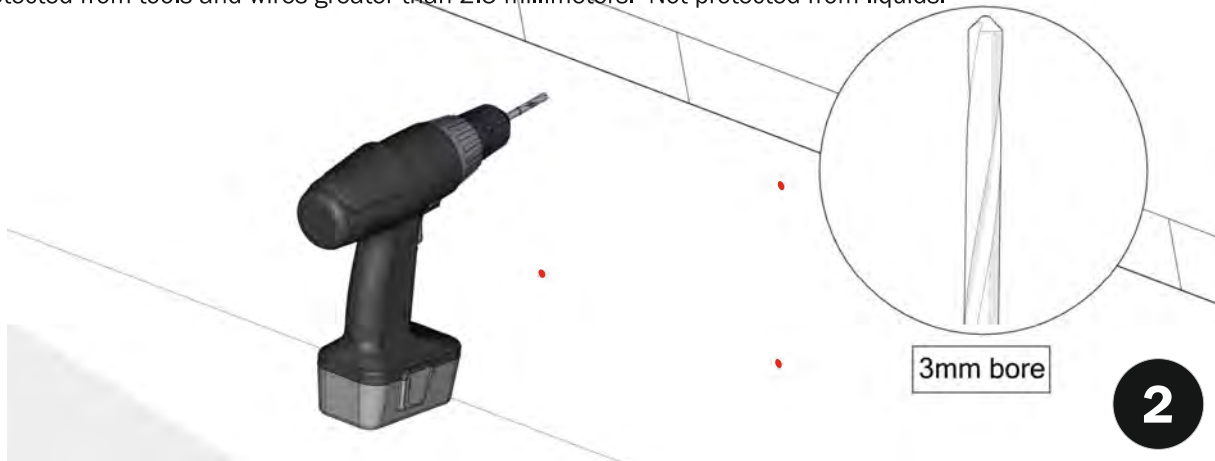

### Air Unit Installation

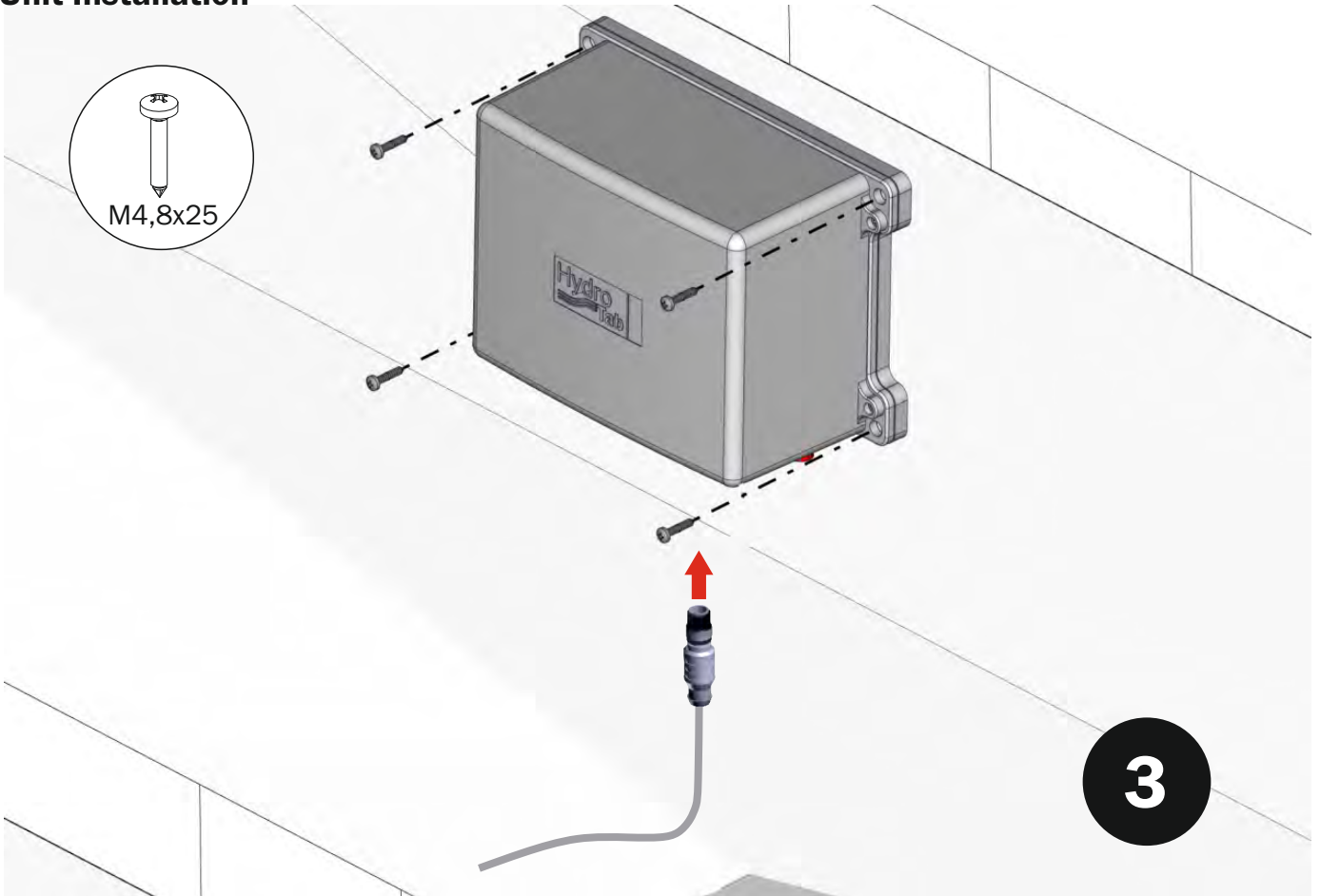

### Pneumatic Connection

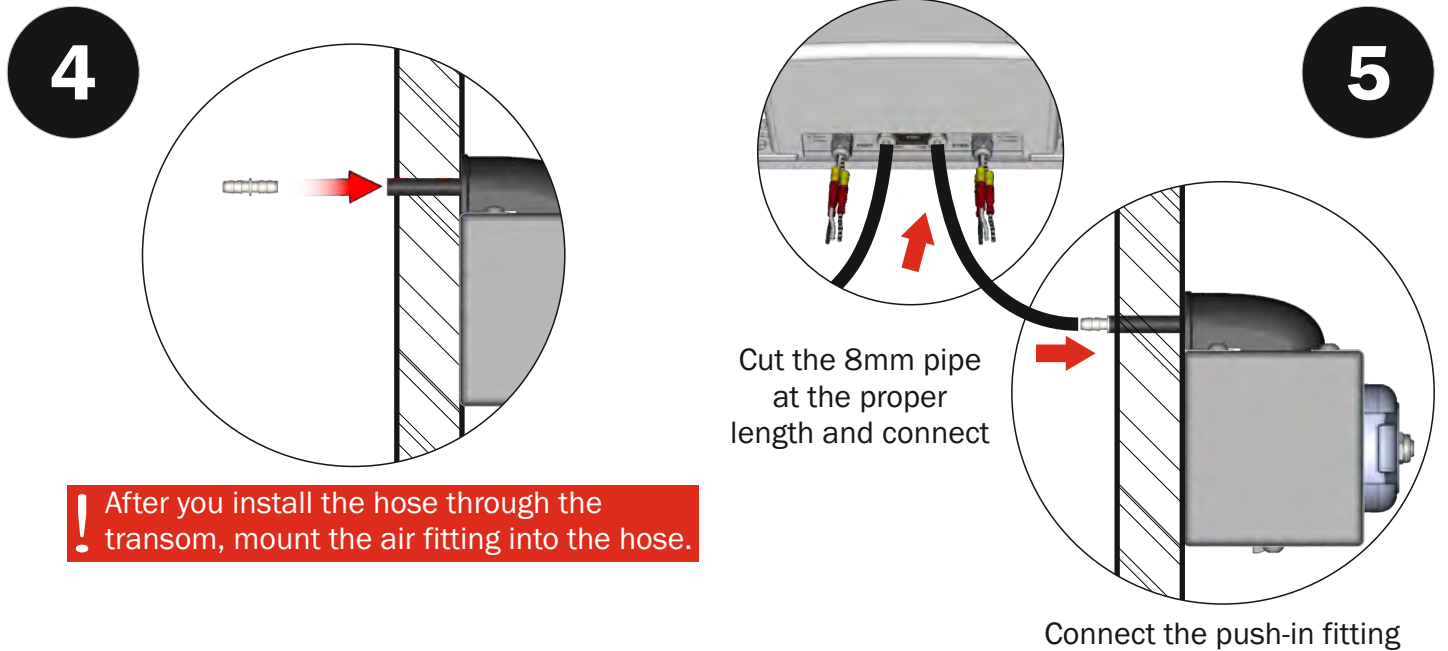

### Installation Schematic overview (One Set of Rocker Switches)

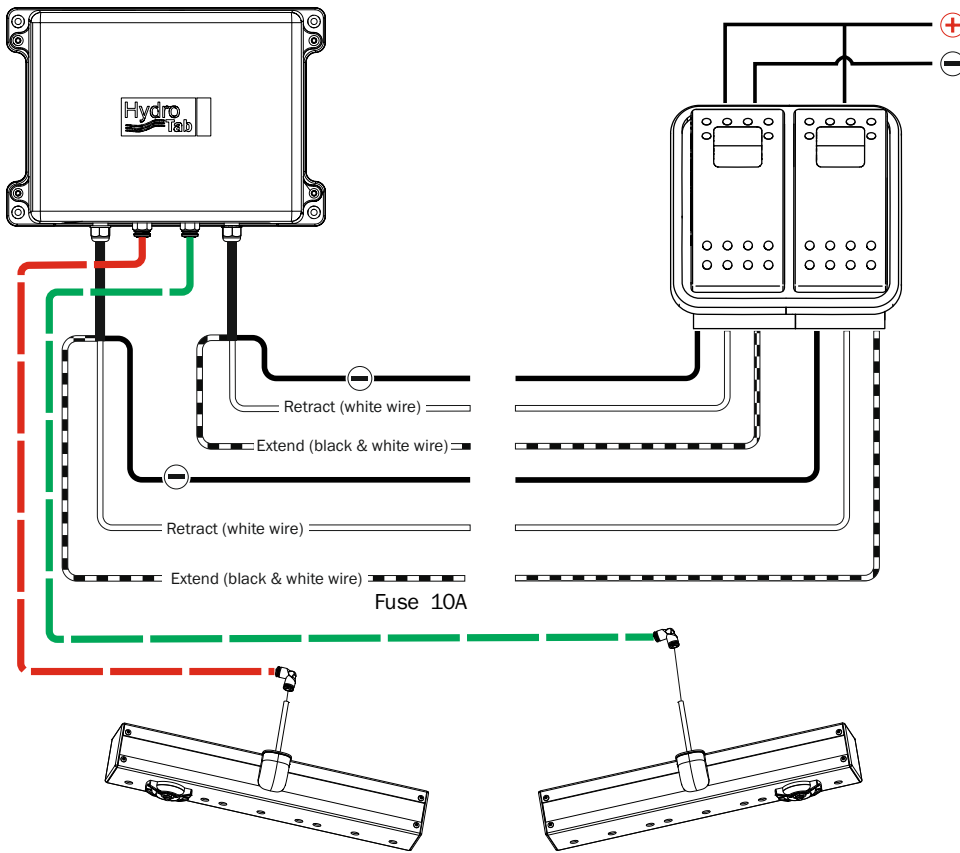

**Attention!**

PORT      AIR UNIT ECO      STBD

12VDC      FUSE 10A

● Extend  
○ Retract

● Extend  
○ Retract

\*Advice the fusing table and ensure that you apply the right fuse according to your boat's voltage.

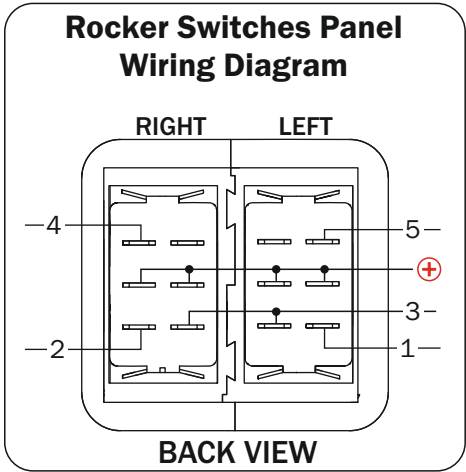



### Electrical Diagram

**Attention!**

AIR UNIT ECO  
12VDC FUSE 10A

PORT STBD

\*Advice the fusing table and ensure that you apply the right fuse according to your boat's voltage.

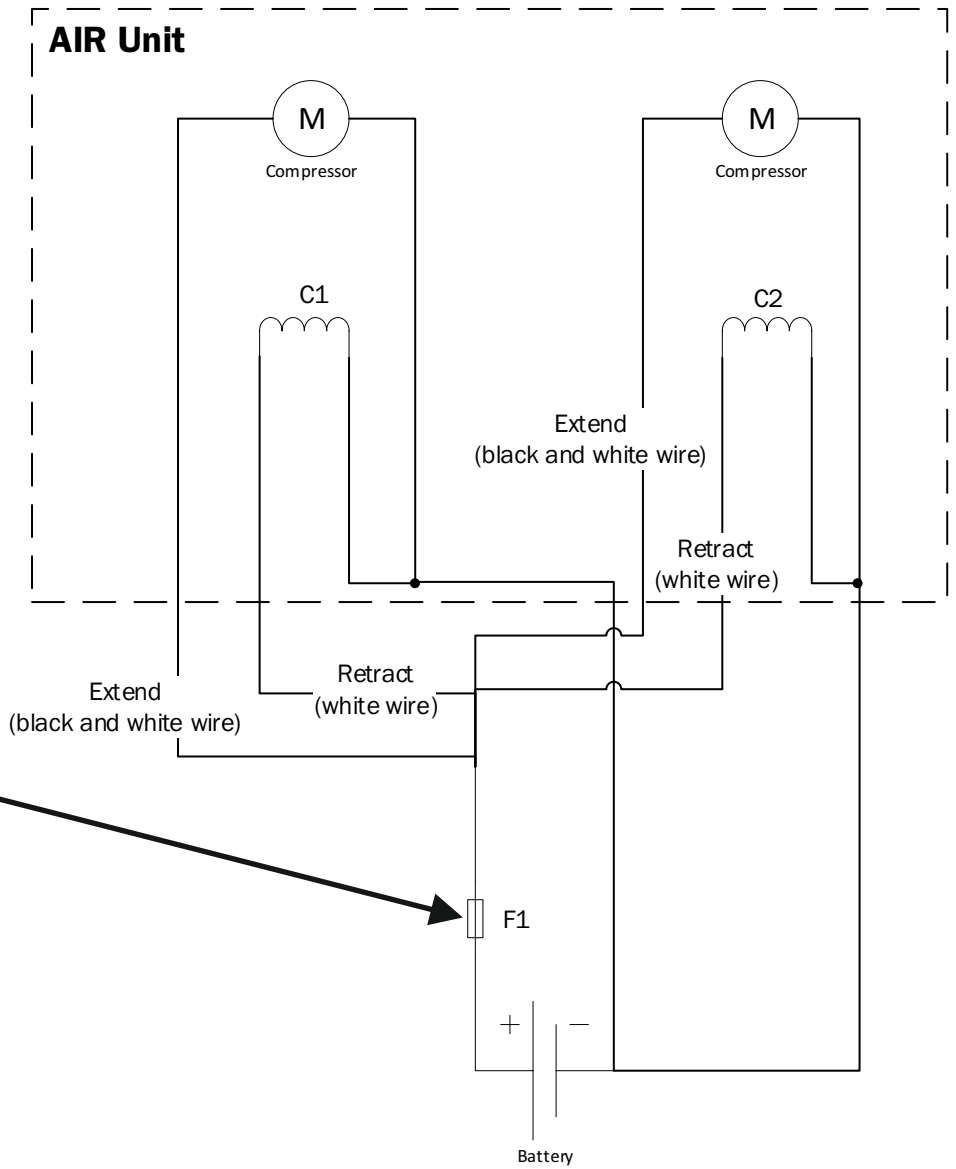

SYMBOL	PART No	DESCRIPTION
C1	PNE-01231C	VALVE COIL
C2	PNE-01231C	VALVE COIL

**C1** Port Valve

**C2** Starboard Valve

# Pneumatic Diagram

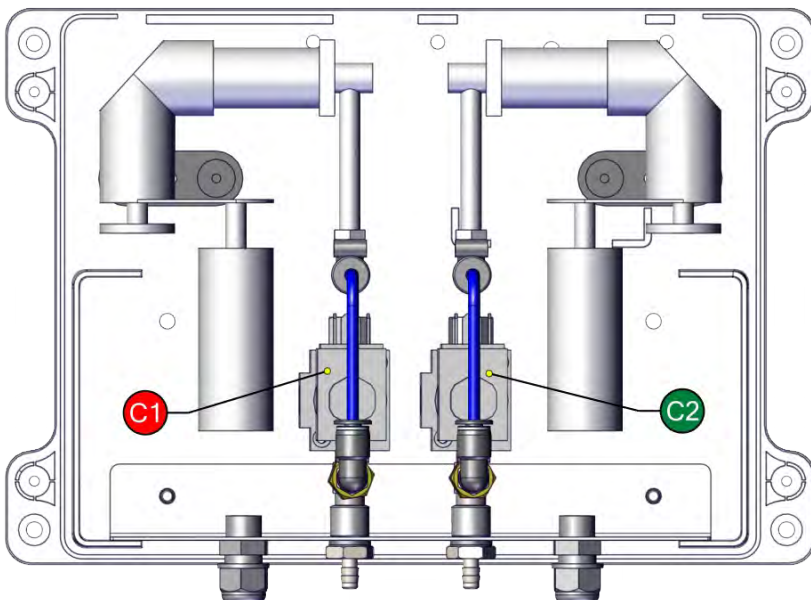
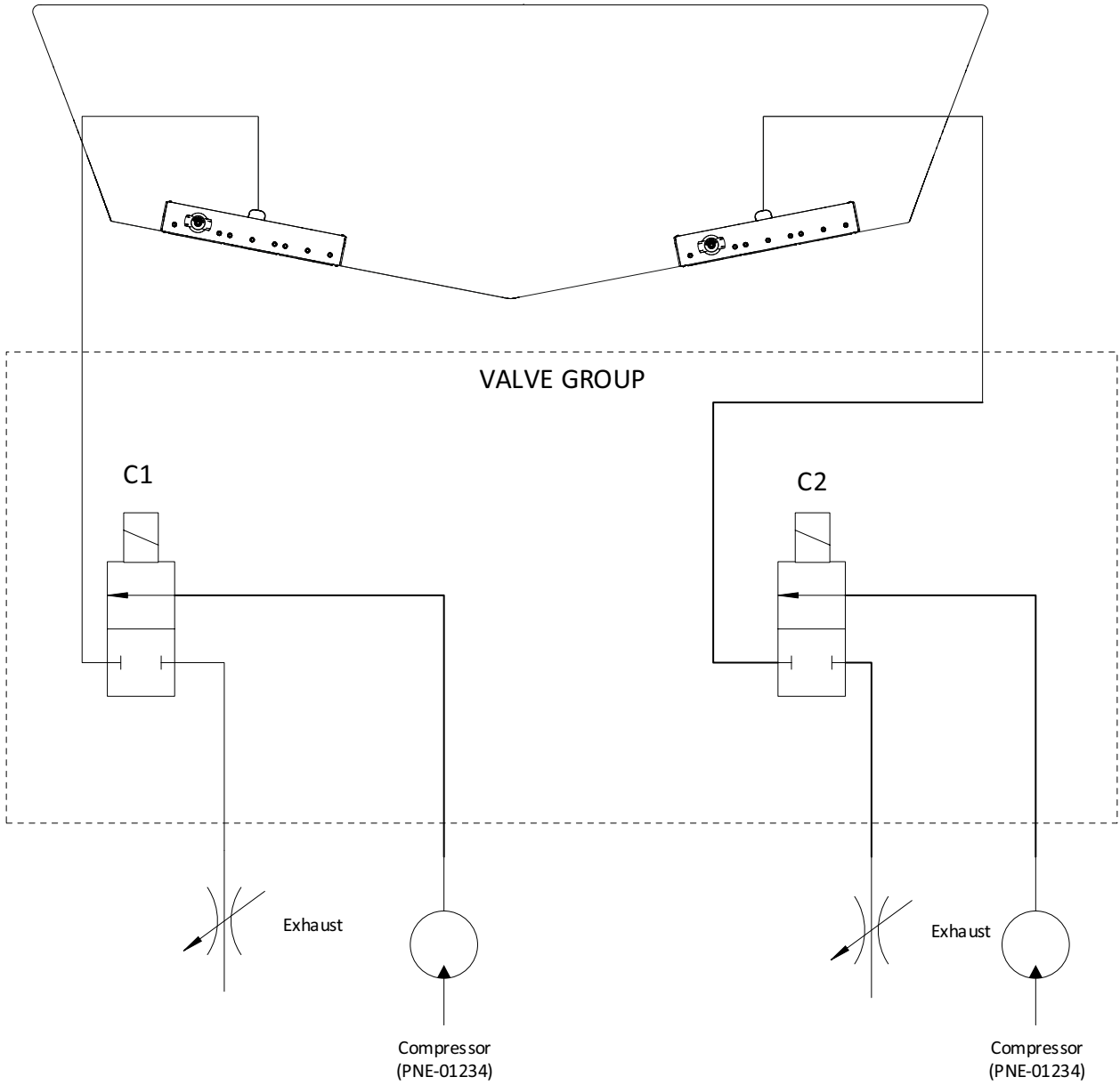

SYMBOL	PART No	DESCRIPTION
C1	PNE-01331C	VALVE COIL
C2	PNE-01331C	VALVE COIL

**C1** Port Valve

**C2** Starboard Valve

Spare parts list

**MOD: 160BT (ASM-00928)**

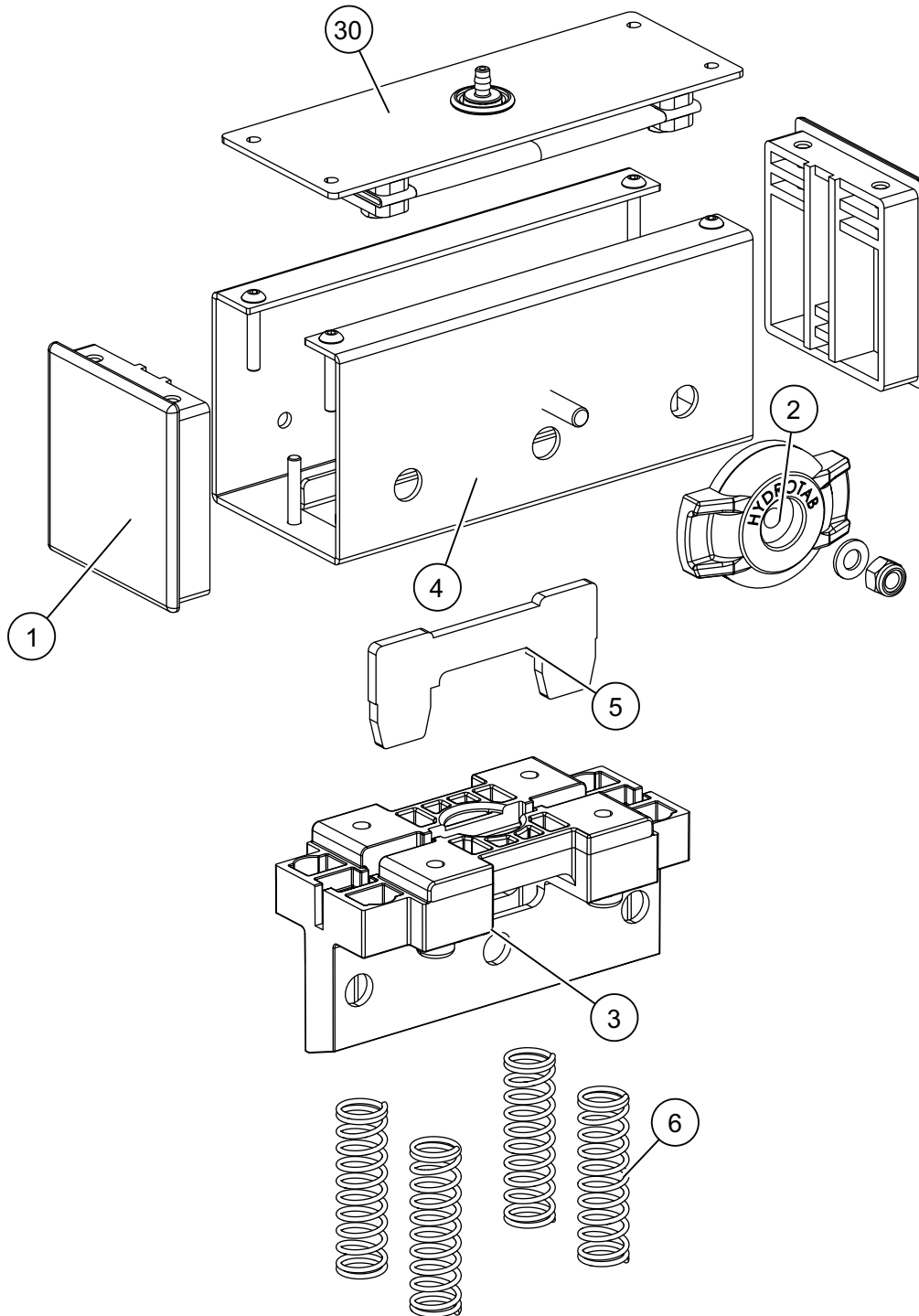

BOM ID	PartNo	Description	Qty
1	GEN-00276	SIDE CAP	2
2	GEN-00279	ANODE	1
3	GEN-00290	BLADE	1
4	LAS-00826	HOUSING, 160BT	1
5	LAS-00851	HOLDING BLADE PLATE, 160BT	1
6	SPR-00025	SPRING	4
30	ASM-00999	TUBULAR ASSEMBLY, 160BT	1

Spare parts list

**MOD: 320BT (ASM-00560)**

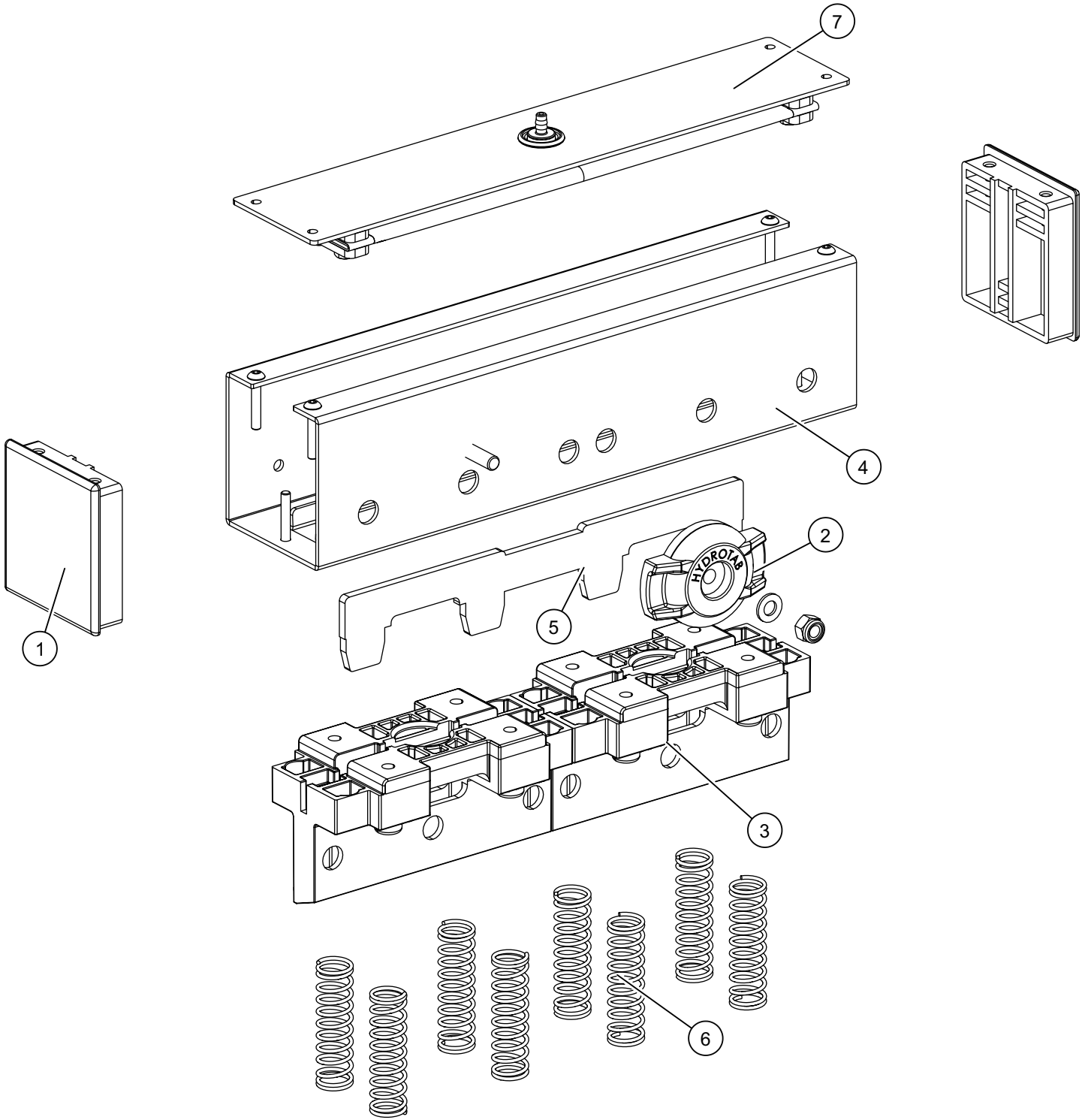

BOM ID	PartNo	Description	Qty
1	GEN-00276	SIDE CAP	2
2	GEN-00279	ANODE	1
3	GEN-00290	BLADE	2
4	LAS-00479	HOUSING, 320BT	1
5	LAS-00489	HOLDING BLADE PLATE, 320BT	1
6	SPR-00025	SPRING	8
7	ASM-00550	TUBULAR ASSEMBLY, 320BT	1

Spare parts list

**MOD: 480BT (ASM-00561)**

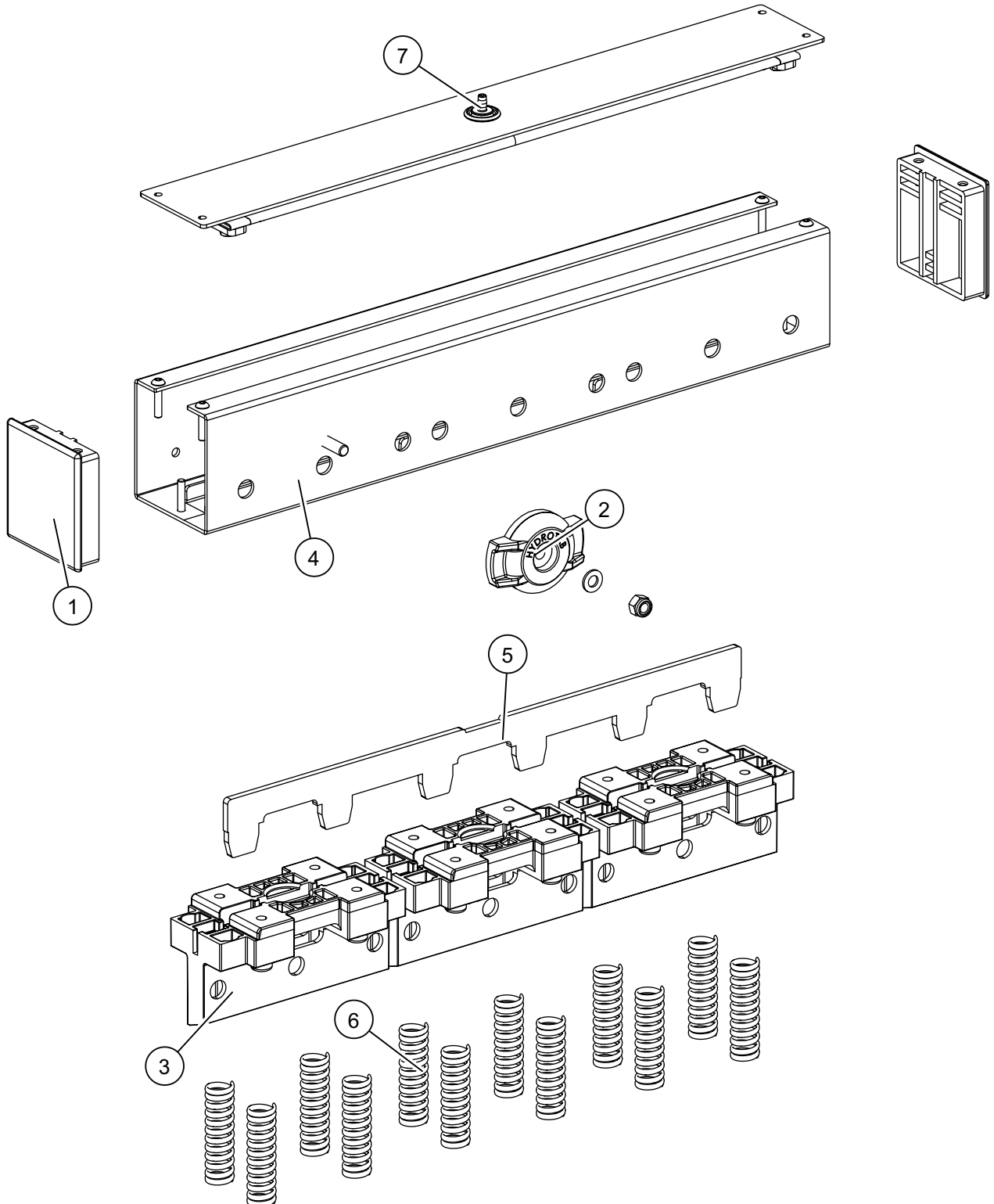

BOM ID	PartNo	Description	Qty
1	GEN-00276	SIDE CAP	2
2	GEN-00279	ANODE	1
3	GEN-00290	BLADE	3
4	LAS-00480	HOUSING, 480BT	1
5	LAS-00490	HOLDING BLADE PLATE, 480BT	1
6	SPR-00025	SPRING	12
7	ASM-00551	TUBULAR ASSEMBLY, 480BT	1

Spare parts list

**MOD: 640BT (ASM-00562)**

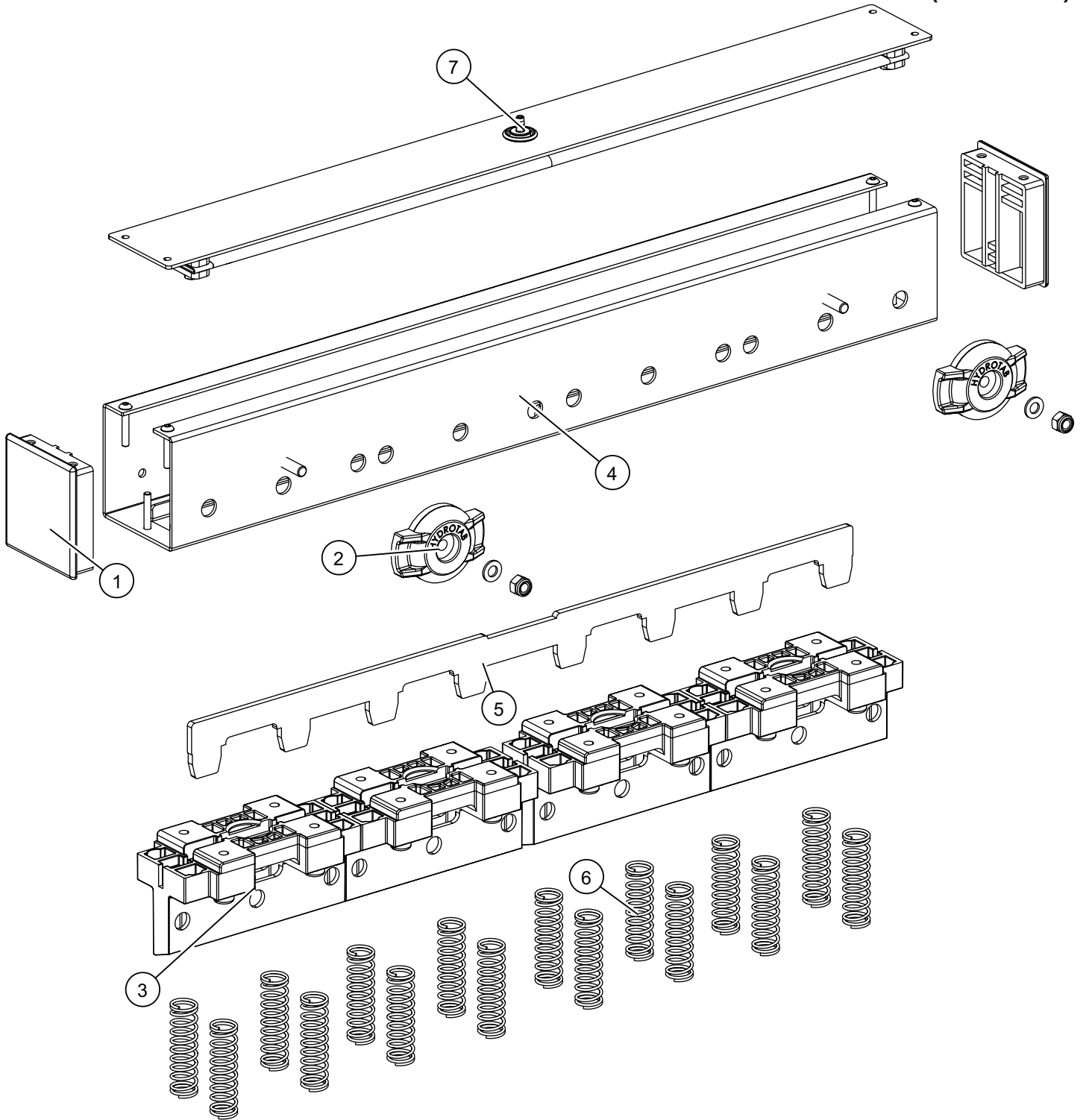

BOM ID	PartNo	Description	Qty
1	GEN-00276	SIDE CAP	2
2	GEN-00279	ANODE	2
3	GEN-00290	BLADE	4
4	LAS-00481	HOUSING, 640BT	1
5	LAS-00491	HOLDING BLADE PLATE, 640BT	1
6	SPR-00025	SPRING	16
7	ASM-00552	TUBULAR ASSEMBLY, 640BT	1

Spare parts list

**MOD 800BT (ASM-00563)**

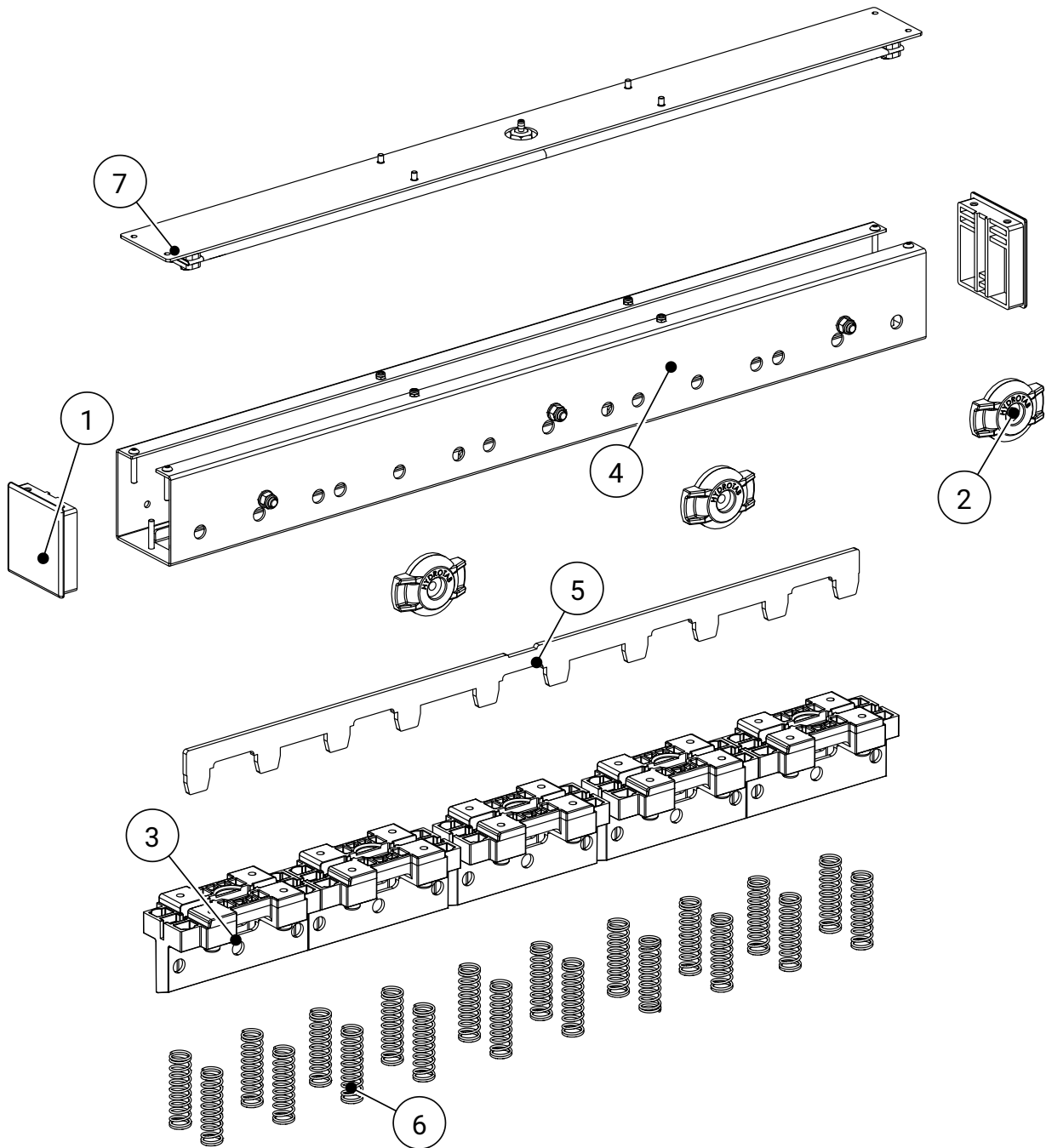

BOM ID	PartNo	Description	Qty
1	GEN-00276	SIDE CAP	2
2	GEN-00279	ANODE	3
3	GEN-00290	BLADE	5
4	LAS-00482	HOUSING, 800BT	1
5	LAS-00492	BLADE HOLDER, 800BT	1
6	SPR-00025	SPRING	20
7	ASM-00553	TUBULAR ASSEMBLY, 800BT	1

Spare parts list

**MOD: 960BT (ASM-00564)**

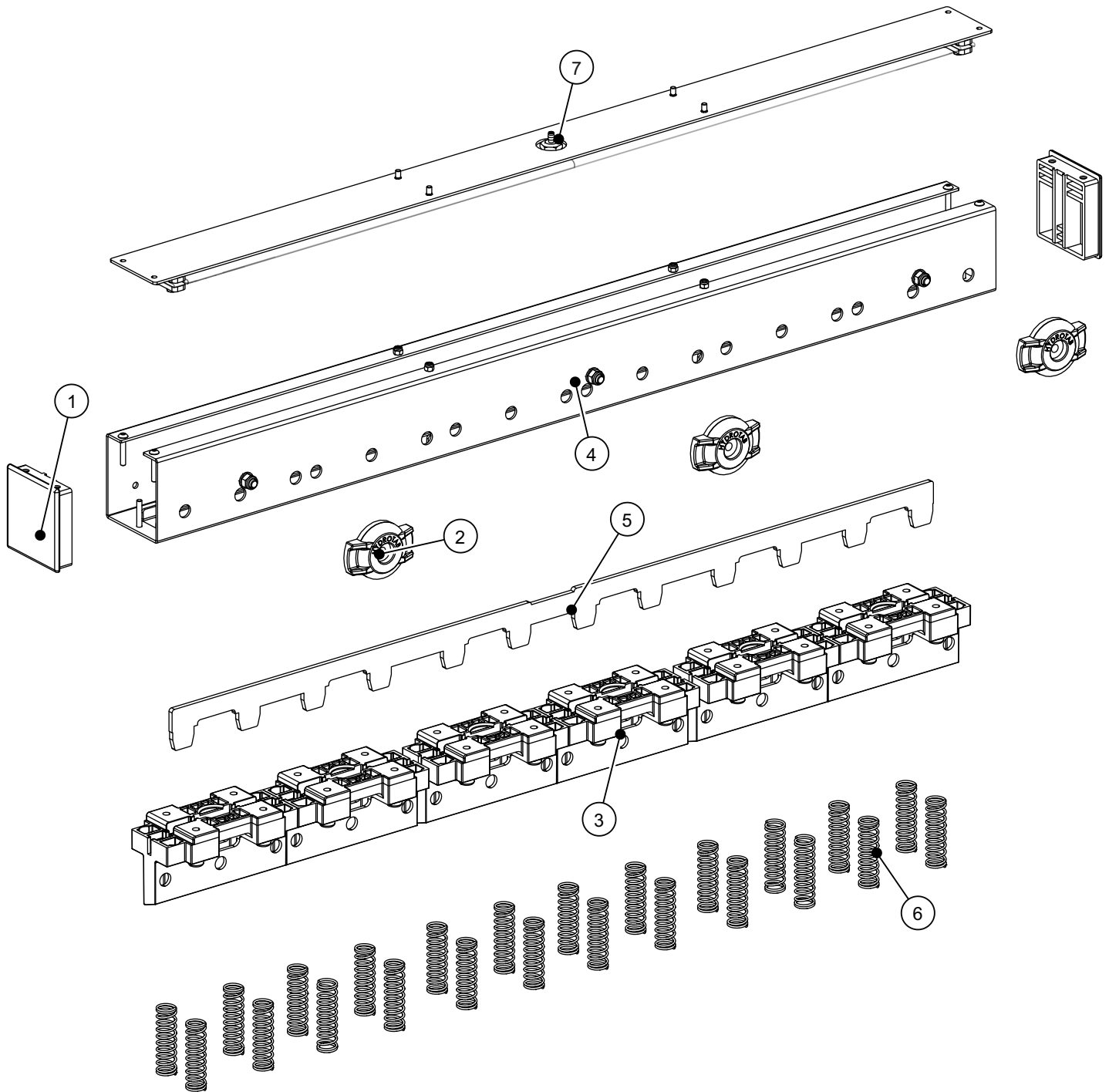

BOM ID	PartNo	Description	Qty
1	GEN-00276	SIDE CAP	2
2	GEN-00279	ANODE	3
3	GEN-00290	BLADE	6
4	LAS-00483	HOUSING, 960BT	1
5	LAS-00493	BLADE HOLDER, 960BT	1
6	SPR-00025	SPRING	24
7	ASM-00554	TUBULAR ASSEMBLY, 960BT	1



Spare parts list

**MOD: 1500BT (ASM-0940)**

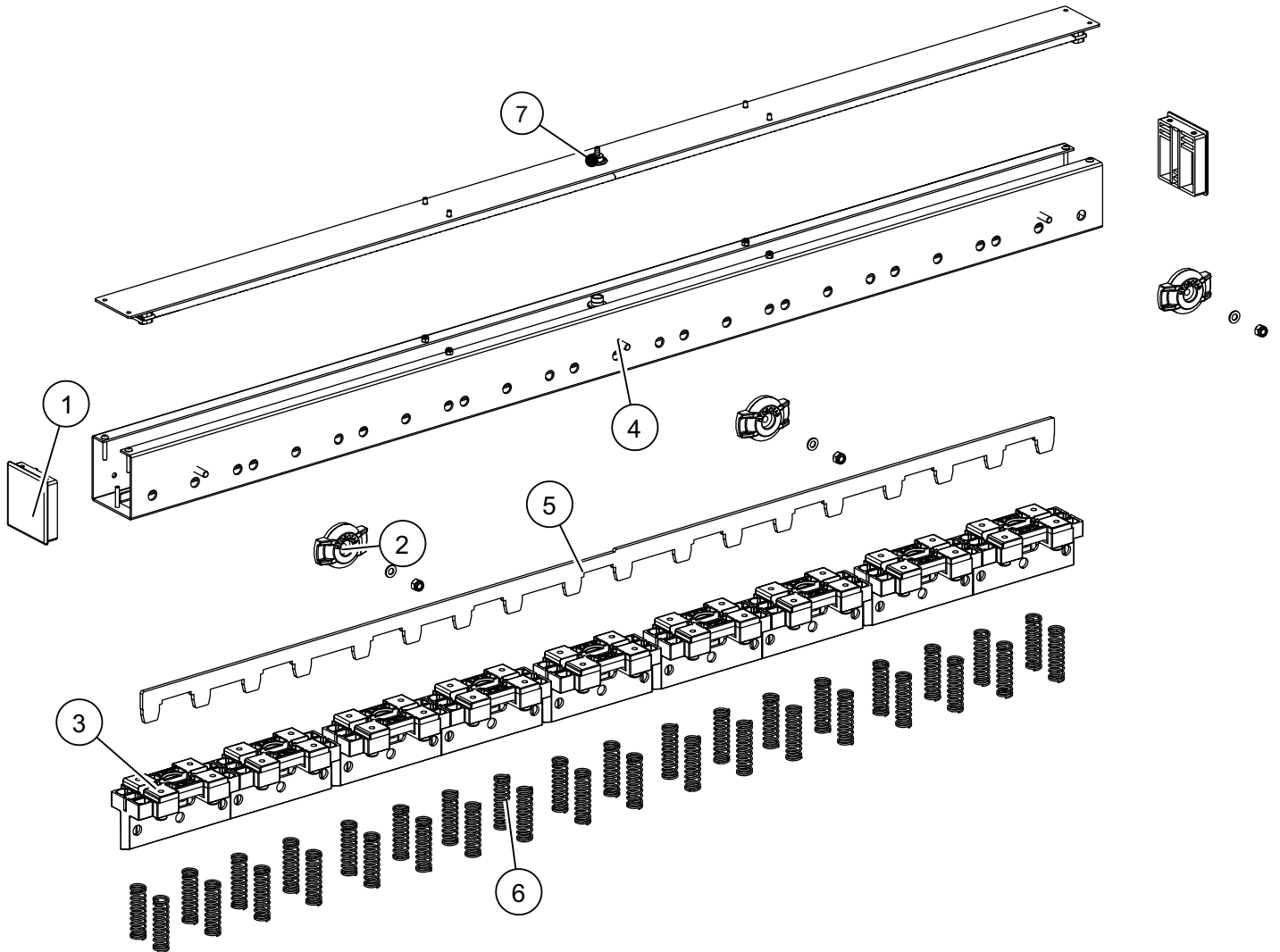

BOM ID	PartNo	Description	Qty
1	GEN-00276	SIDE CAP	2
2	GEN-00279	ANODE	3
3	GEN-00290	BLADE	9
4	LAS-00832	HOUSING, 1500BT	1
5	LAS-00834	HOLDING BLADE PLATE, 1500BT	1
6	SPR-00025	SPRING	36
7	ASM-01009	TUBULAR ASSEMBLY, 1500BT	1

### Spare parts list

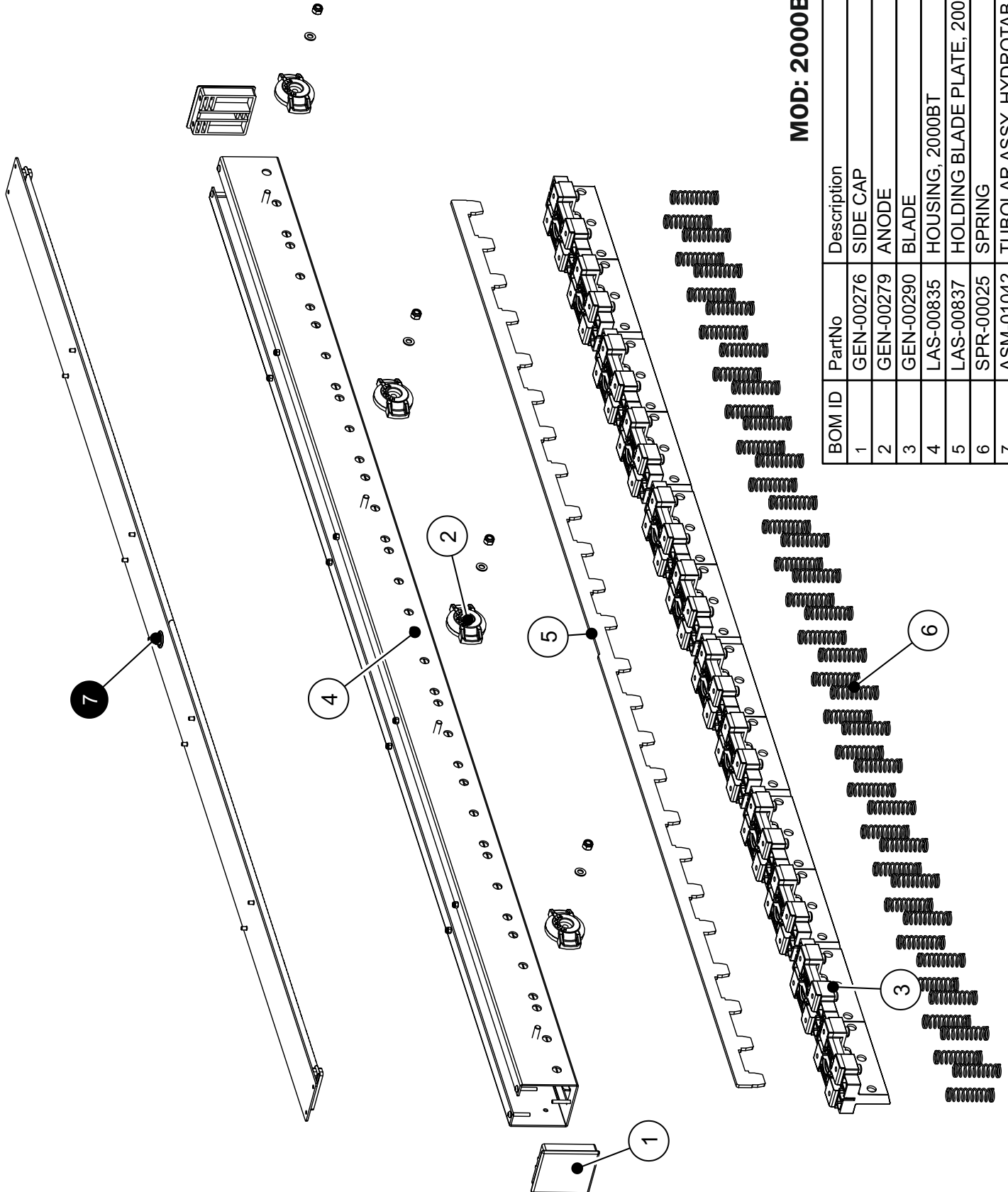

**MOD: 2000BT (ASM-0941)**

BOM ID	PartNo	Description	Qty
1	GEN-00276	SIDE CAP	2
2	GEN-00279	ANODE	4
3	GEN-00290	BLADE	12
4	LAS-00835	HOUSING, 2000BT	1
5	LAS-00837	HOLDING BLADE PLATE, 2000BT	1
6	SPR-00025	SPRING	48
7	ASM-01042	TUBOLAR ASSY, HYDROTAB 1500BT	1

Spare Parts

**Air Unit (ASM-01332-RC)**

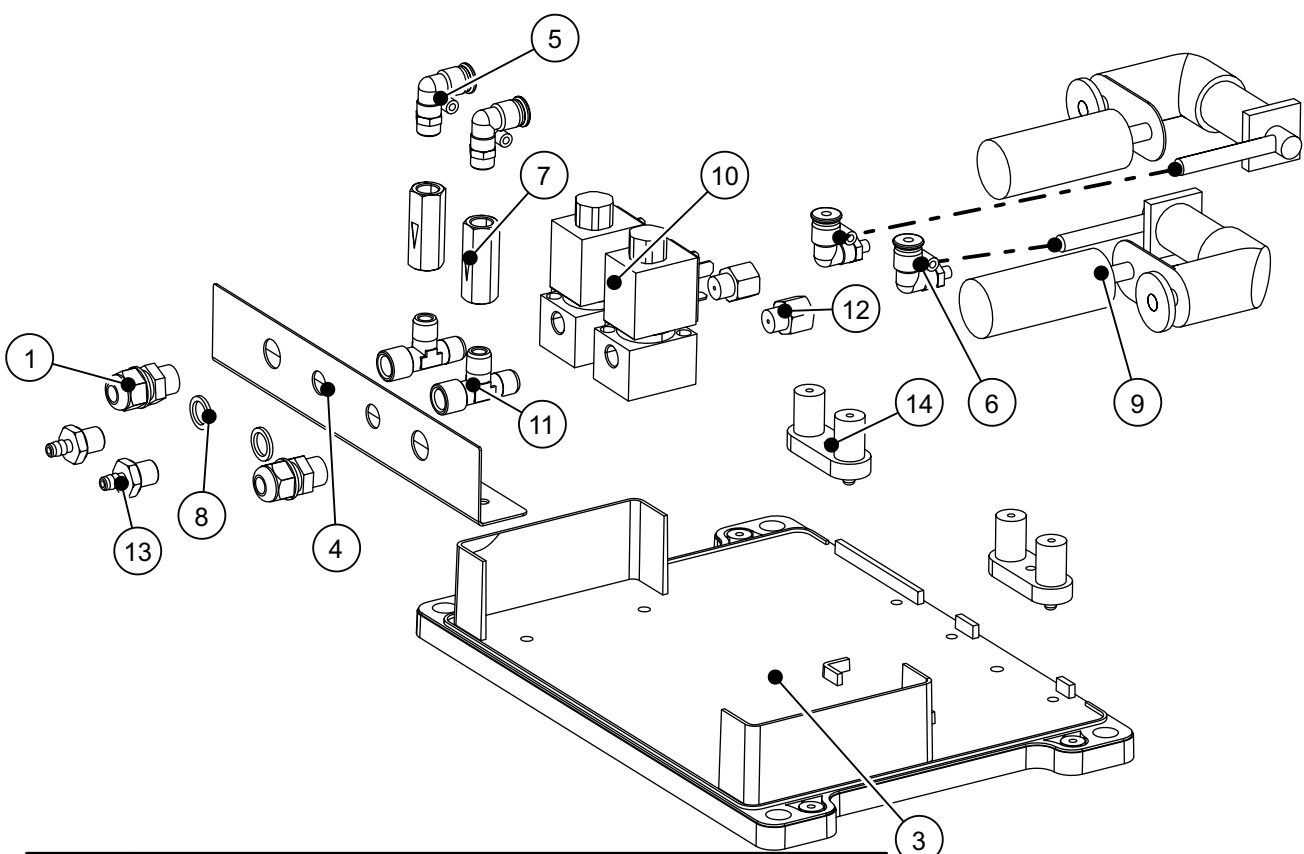
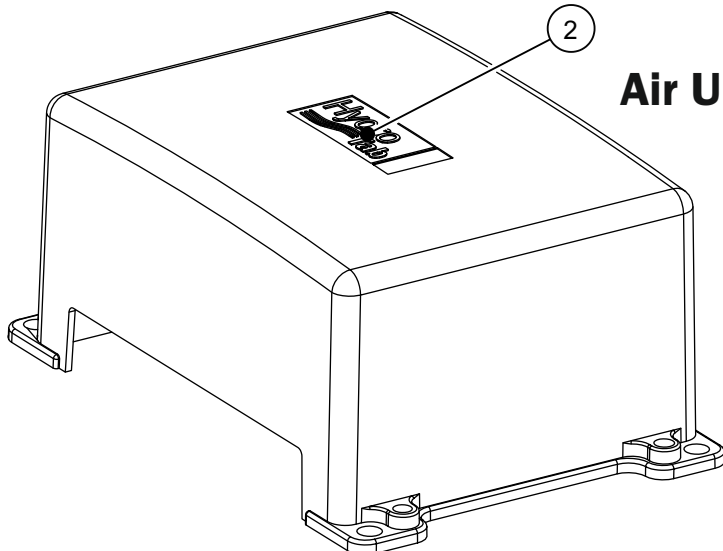

BOM ID	PART NUMBER	DESCRIPTION	QTY.
1	ELE-00703	CABLE GLAND P7	2
2	GEN-00156	TOP COVER	1
3	GEN-00157	BASE	1
4	LAS-01257	HOLDING FLANGE	1
5	PNE-00029	FITTING, ELBOW, 1/8 - $\Phi$ 4	2
6	PNE-00030	FITTING, ANGLE, M5 - $\Phi$ 4	2
7	PNE-00597	NON RETURN VALVE 1/8 (F) - 1/8 (F)	2
8	PNE-00721	WASHER, 1/8	2
9	PNE-01234	AIR COMPRESSOR AC 12V	2
10	PNE-01331	SOLENOID VALVE 3/2 1/8 NC DC12V	2
11	PNE-01332	TEE M-F-M 1/8	2
12	REV-00097	REDUCTOR, 1/8 (M) - 1/8 (F) - HOLE $\Phi$ 1.5	2
13	REV-00588	FITTING	2
14	RUB-00164	MOTOR RUBBER SUPPORT	2

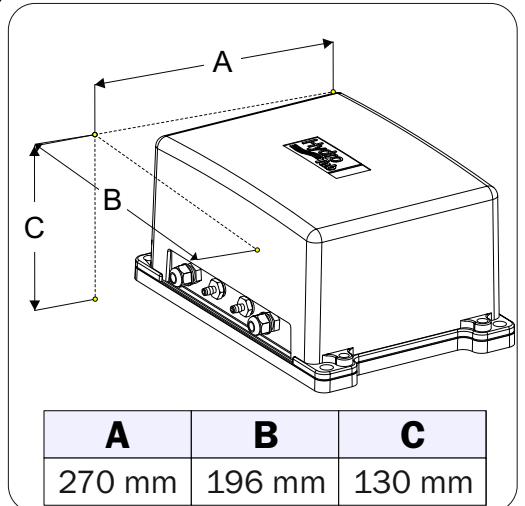

## Warranty conditions

FW, TS and BT Series Interceptor units (and not complete systems) are covered by a 5-year Warranty.

SR Series Interceptor units (and not complete systems) are covered by a 2-year Warranty.

Recoil springs, electrical/electronic parts and devices come with a 2-year warranty.

Anodes (consumables) are not included in the warranty (for BT, FW, TS Series).

Hydrotab's warranty only covers the repair or replacement of spare parts.

## System selections

It is the sole responsibility of the buyer to choose the correct system and even with Hydrotab's suggestion for a system, the overall responsibility is with the buyer.

## Limited warranty

Provided that the system has been installed in accordance with the installation manual we provide, and no damage has been caused due to improper handling or practices, Hydrotab will replace any defective parts or parts that failed due to improper manufacturing within the applicable warranty period.

Hydrotab only covers the parts' replacement. Fitting or shipping costs are not covered by warranty.

Hydrotab will select if we will repair or replace any given part.

Repaired or replaced products will assume the remainder of the warranty time and under no conditions will the full time of warranty be renewed.

## Limited warranty periods

Limited warranty period is two years (2 years) from the product shipment from our premises.

## Extended limited warranty period

It is provided in case:

- a) Hydrotab trim system is included as equipment of a newly purchased boat directly by from the boat-builder or his reseller.
- b) Hydrotab trim system has been purchased through a Hydrotab dealer.

The extended limited warranty period is valid for three (3) years from the shipping date, provided that the customer has downloaded, completed and submitted the online registration form within one month (30) days from the purchase in the following url.

<https://www.hydrotab.gr/product-registration>

In case the dealer sells separate units of Interceptors, Air Units and Controllers that constitute a full system that is not initially sold (as a complete system) by Hydrotab, the dealer has the responsibility to provide the separate Serial Numbers for the Interceptors, Air Units and Controllers and guide the end user for the proper registration of his serial numbers for the extended warranty to be valid.

The authorized dealer is responsible for the product's service.

For any services or spare parts requirements and replacements during warranty period, the original invoice is necessary to be presented.

For the replacement of any part of the system (interceptors, Air Unit, any controller etc.) under warranty, the replaced parts must be returned to Hydrotab Marine Engineering for inspection, otherwise warranty is not valid.

Cost of dismantling - assembly and spare parts transportation is borne by the user.

The warranty does not foresee, under any circumstances, replacement of the whole Hydrotab system.

## What is not covered by the warranty:

Damage caused by the lack or non-replacement of worn anodes (for BT, FW, TS Series).

Damage caused by improper installation and use not consistent with the manual.

Damage with external visible deformation of the product caused by misuse of the user or other external causes.

Damage to any component caused during transportation, installation or repair from non-authorized personnel.

Conversions or modifications made after the initial sale.

N. Triantafyllis Ltd (Hydrotab Marine Engineering) is not liable for any incidental, indirect or consequential damages or losses, including,

without limitation: travel expenses, transport, lifting and hauling, costs, loss of income, loss of time, loss of property, loss of profits, personal injury or damage of any products, different from those that the company distributes. Any further (except the above mentioned) commitment of the intermediate dealer regarding the sale terms or servicing of Hydrotab products does not create any liability of our company.

# Troubleshooting

Before attempting any fault finding, check all fuses and that there is electric power to all connections

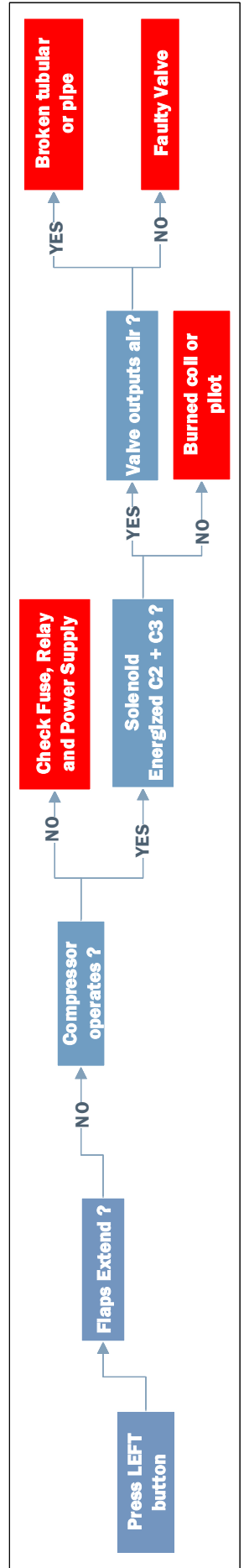
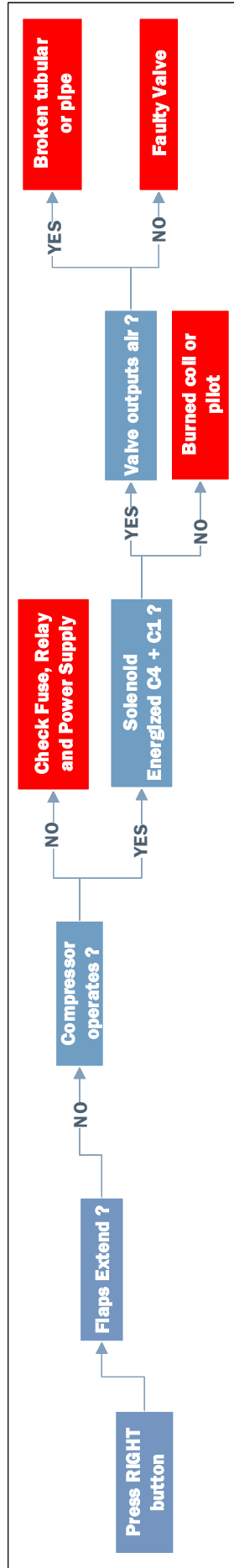
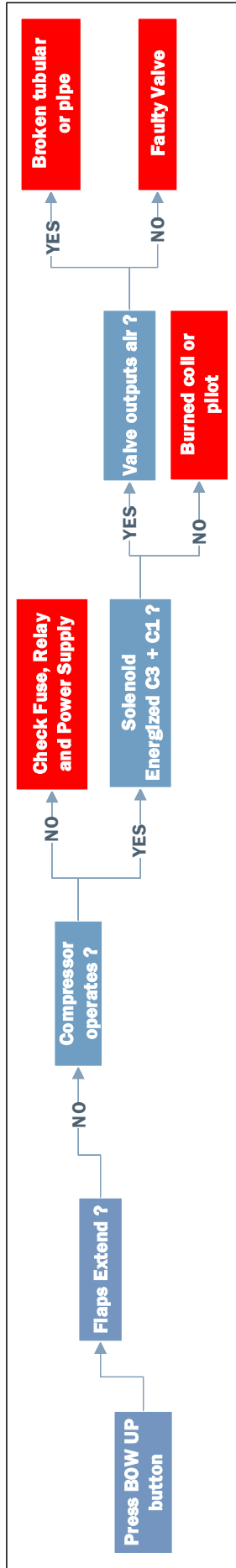
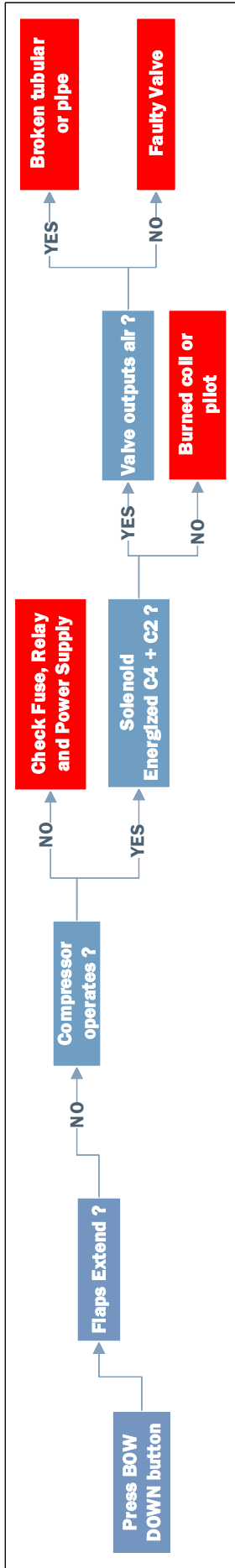







4, Papazoglou str.  
GR-17778 Athens  
Greece  
email: [info@hydrotab.gr](mailto:info@hydrotab.gr)  
website: [www.hydrotab.gr](http://www.hydrotab.gr)